

N20021 | STEEL

N20022 | ALU

EVOS IN-RAIL KIT

A

+

I

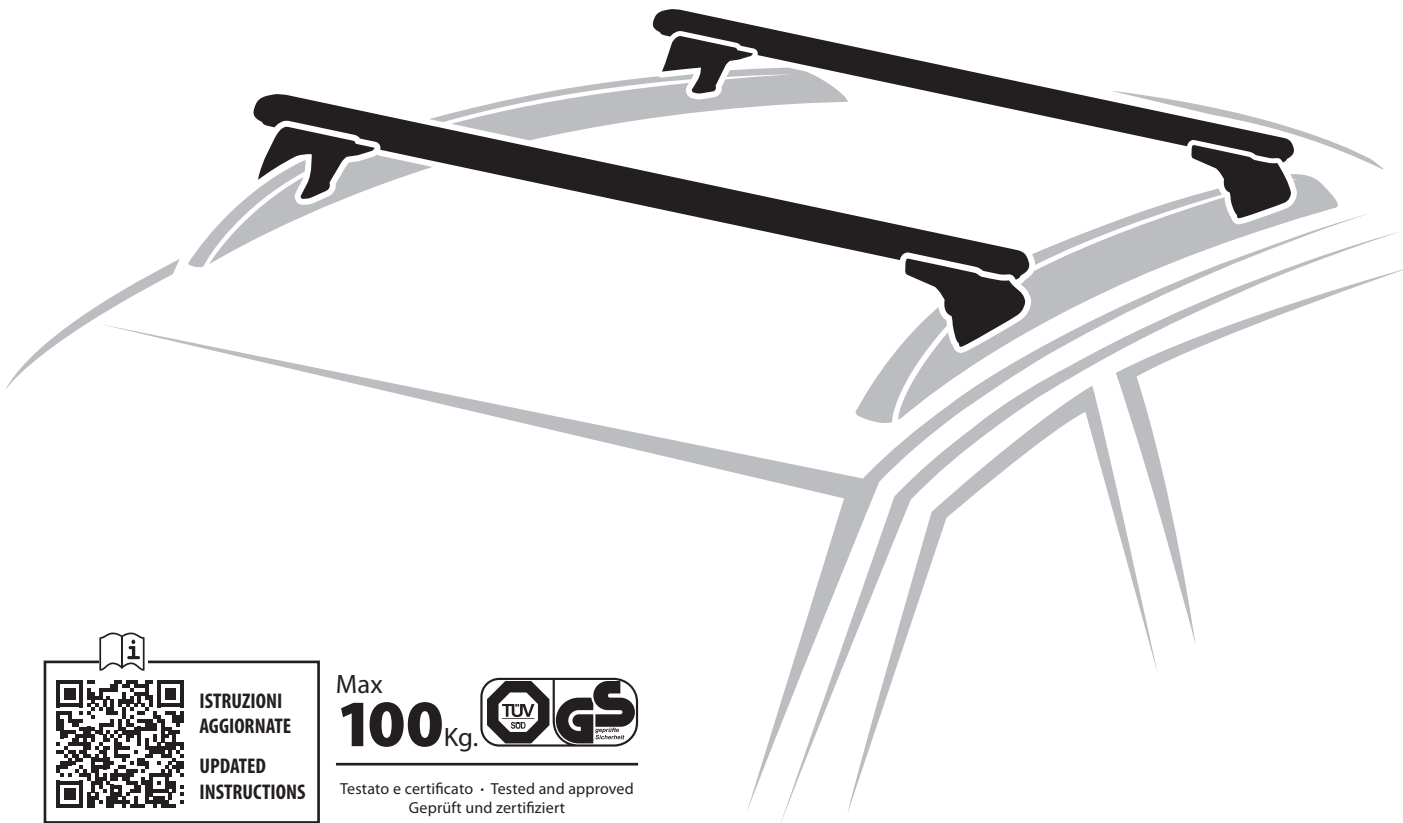

Max
100 Kg.  

Testato e certificato · Tested and approved
Geprüft und zertifiziert

91CA0111 r07

I Istruzioni di montaggio

EN Fitting instructions

F Instructions de montage

D Montageanleitung

E Instrucciones de montaje

P Instruções de montagem

NL Montage-instructies

S Monteringsanvisning

FIN Asennusohje

EST Paigaldusjuhend

LAT Stiprināšanas instrukcija

LT Pritvirtinimo instrukcijos

PL Instrukcja montażu

RUS Инструкции по установке

CZ Návod na montáž

SK Návod na montáž

SLO Navodila za pritrjevanje

HR Uputa za sastavljanje

H A felszerelés módja

GR Οδηγίες συναρμολόγησης

TR Montaj talimatları

BG Инструкции за монтаж

SRB Uputstva za montažu



Safety Regulations

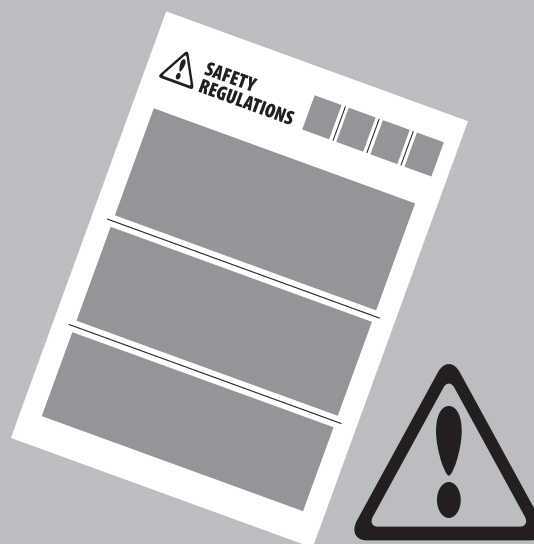
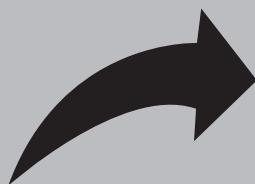

- I** Leggere il libretto di sicurezza e garanzia incluso nel prodotto prima dell'uso. Per maggiori informazioni visita il sito **www.nordrive.it** o contattare direttamente il rivenditore locale.
- EN** Before using this product, please read the enclosed safety and warranty booklet. For more information please visit **www.nordrive.it** or contact your local dealer.
- F** Avant d'utiliser ce produit, veuillez lire le livret de sécurité et de garantie inclus. Pour plus d'informations, visitez le site **www.nordrive.it** ou contactez votre revendeur local.
- D** Bevor die Verwendung des Produkts, die Sicherheitsbroschüre und Garantieheft lesen. Für weitere Informationen empfehlen wir Ihnen die Webseite **www.nordrive.it** zu besuchen oder direkt den örtlichen Wiederkäufer zu kontaktieren.
- E** Antes de usar este producto, lea el folleto de seguridad y garantía incluido. Para obtener más información, visite **www.nordrive.it** o póngase en contacto con su distribuidor local.
- P** Antes de usar este produto, por favor leia o livro de segurança e garantia incluso. Para obter mais informações, visite **www.nordrive.it** ou entre em contato com seu revendedor local.
- NL** Lees voor het gebruik van dit product het bijgevoegde veiligheids- en garantieboekje. Ga voor meer informatie naar **www.nordrive.it** neem contact op met uw lokale dealer.
- S** Före användning av denna produkt, vänligen läs den medföljande broschyren om säkerhet och garantivillkor. För mer information vänligen besök **www.nordrive.it** eller kontakta er lokala återförsäljare.
- FIN** Ennen kuin käytät tätä tuotetta, lue mukana toimitettu turva- ja takuukirja. Lisätietoja on osoitteessa **www.nordrive.it** tai ota yhteys paikalliseen jälleenmyyjään.
- EST** Enne toote kasutamist tutvuge kaasasoleva ohutus- ja garantiijuhendiga. Lisateabe saamiseks külastage veebisaiti **www.nordrive.it** või pöörduge kohaliku edasimüüja poole.
- LAT** Pirms šī produkta izmantošanas, lūdzu, izlasiet pievienoto drošības un garantijas bukletu. Lai iegūtu vairāk informācijas, lūdzu, apmeklējiet vietni **www.nordrive.it** vai sazinieties ar vietējo izplatītāju.
- LT** Prieš pradėnant naudoti šį produktą, prašome perskaityti pridėtus saugos ir garantinius lapus. Daugiau informacijos rasite apsilankę **www.nordrive.it** arba tiesiogiai susisiekdami su mūsų vietiniu atstovu.
- PL** Przed użyciem tego produktu prosimy o zapoznanie się z załączoną książeczką bezpieczeństwa i gwarancji. Aby uzyskać więcej informacji, odwiedź **www.nordrive.it** lub skontaktuj się z lokalnym sprzedawcą.
- RUS** Перед использованием продукта ознакомьтесь с буклетом по технике безопасности и гарантией. Для получения дополнительной информации рекомендуем посетить сайт **www.nordrive.it** или обратиться непосредственно к местному дилеру.
- CZ** Před použitím produktu si přečtěte přiloženou bezpečnostní a záruční brožuru. Další informace najdete na **www.nordrive.it** nebo přímo u místního prodejce.
- SK** Pred použitím produktu, prosím naštudujte najprv priložený manuál a bezpečnostné pokyny. Pre viac informácií prosím navštívte **www.nordrive.it** alebo kontaktujte miestneho predajcu/ zástupcu.
- SLO** Pred uporabo proizvoda preberi priložena navodila in garancijsko izjavo. Za več informacij obiščite internetno stran **www.nordrive.it** ali kotaktirajte lokalnega prodajalca.
- HR** Prije uporabe ovog proizvoda, pročitajte priloženo uputstvo o sigurnosti i jamstvu. Za više informacija posjetite **www.nordrive.it** ili kontaktirajte svog lokalnog distributera.
- H** Használat előtt kérjük figyelmesen olvassa el a biztonsági és garanciális útmutatót. Több információért kérjük keresse fel a **www.nordrive.it** weboldalt vagy lépjen kapcsolatba a honi forgalmazóval.
- GR** Πριν χρησιμοποιήσετε το προϊόν, παρακαλούμε διαβάστε το φυλλάδιο ασφάλειας και εγγύησης. Για περισσότερες πληροφορίες, επισκεφθείτε το **www.nordrive.it** ή επικοινωνήστε με τον τοπικό σας αντιπρόσωπο.
- TR** Bu ürünü kullanmadan önce lütfen ekteki güvenli ve garanti kitapçığını okuyun. Daha fazla bilgi için lütfen **www.nordrive.it** adresini ziyaret edin veya yerel bayinizle iletişime geçin.
- BG** Моля преди да използвате този продукт, прочетете инструкциите за безопасност и книжката с гаранционните условия. За повече информация моля посетете **www.nordrive.it** или се свържете с местния дистрибутор.
- SRB** Pre upotrebe ovog proizvoda, pažljivo pročitajte priloženu knjižicu o bezbednosti i garanciji. Za više informacija, molimo vas posetite **www.nordrive.it** ili kontaktirajte lokalnog distributera.



FEET

**N20021 - In-Rail Kit Steel
N20022 - In-Rail Kit Alu**

FEET

Contenuto • Content • Contenu • Inhalt • Contenido

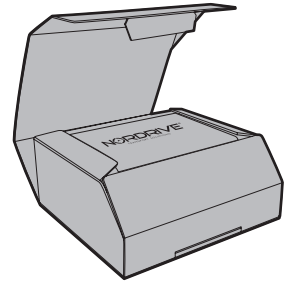

x4

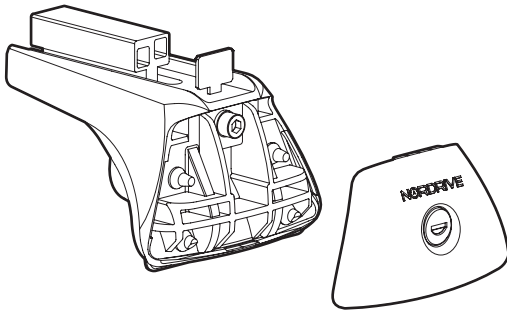

x4

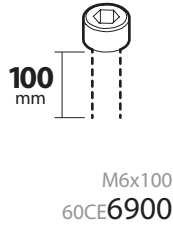

x4

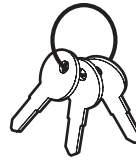

x1

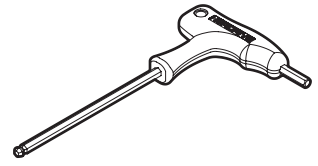

72NA0002



BARS

**Imballo a parte
Separate pack**

BARS

Contenuto • Content • Contenu • Inhalt • Contenido

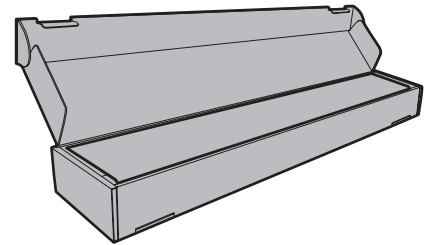

NORDRIVE QUADRA
Acciaio / Steel



NORDRIVE ALUMIA
Alluminio / Aluminium



NORDRIVE HELIO
Alluminio / Aluminium



NORDRIVE SILENZIO
Alluminio / Aluminium

x2

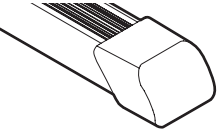

x2

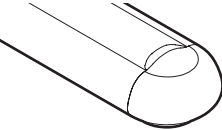

x2

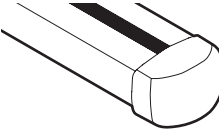

x2

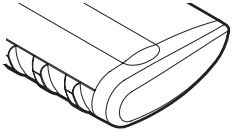

x4

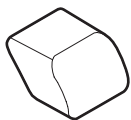

75PL097A

x4



75PL105A

x4



75PL0024

2 + 2

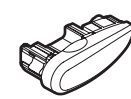

75GR0004
75GR0005

x1

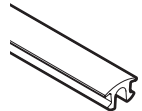

21GO164A

x1

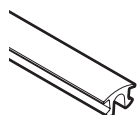

21GO164A

x1

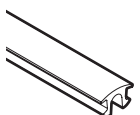

21GO164A

x2

S 21GO0014

M 21GO0001

L 21GO0040

XL 21GO0003

x2

S 21GO0025

M 21GO0026

L 21GO0027

XL 21GO0028

x2

S 21GO0015

M 21GO0016

L 21GO0017

XL 21GO0018

x4

S 21GO0036

M 21GO0037

L 21GO0038

XL 21GO0039

x2

S 21GO0014

M 21GO0001

L 21GO0040

XL 21GO0003



Attenzione • Warning • Attention • Hinweise • Advertencia

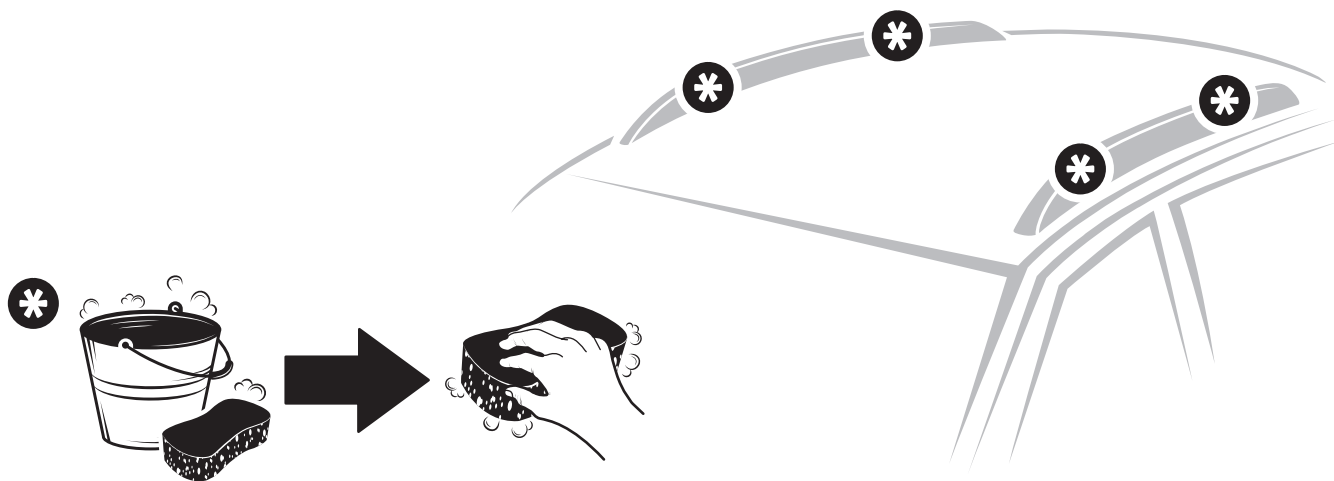

Fronte • Front • Vorderseite



Solo per barre:
Only for bars:
Nur für stangen:



SILENZIO

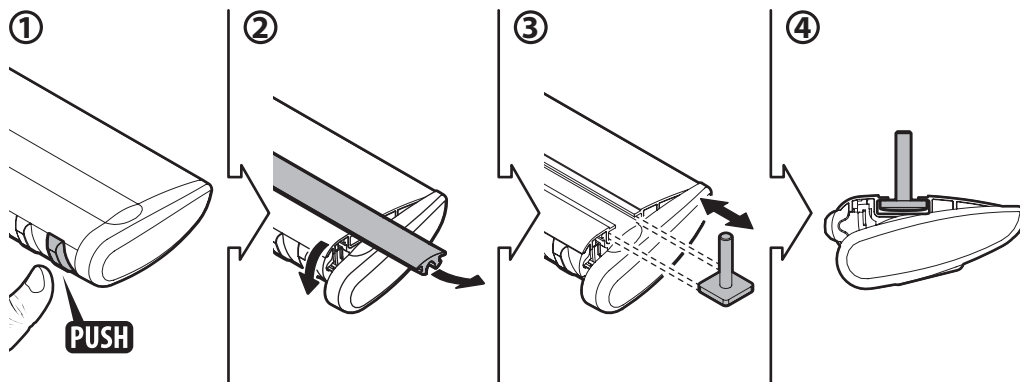
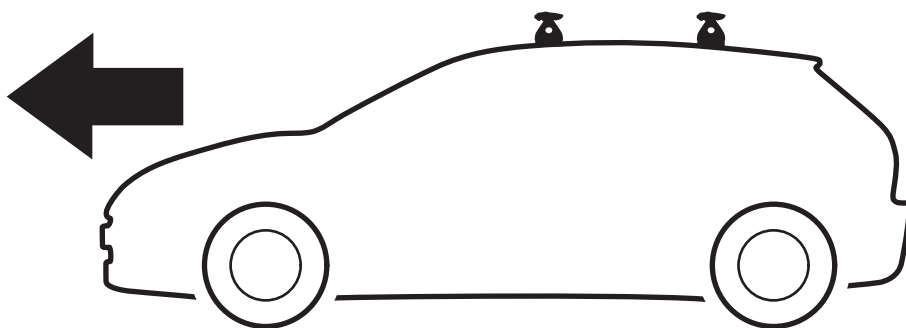



Montaggio • Fitting instructions • Montage • Montageanleitung • Montaje

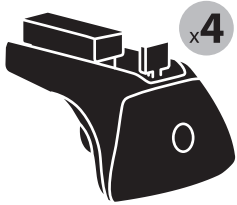

+



=

- S** 2,8 Kg
- M** 3,0 Kg
- L** 3,0 Kg
- XL** 3,2 Kg



+



+



=

Max
90 Kg.

+



=

- S** 4,8 Kg
- M** 5,0 Kg
- L** 5,2 Kg
- XL** 5,6 Kg

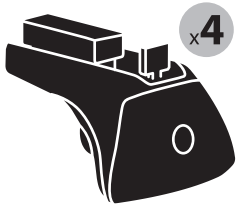

+



=

- S** 3,4 Kg
- M** 3,6 Kg
- L** 3,8 Kg
- XL** 4,0 Kg

+



=

- S** 3,6 Kg
- M** 3,8 Kg
- L** 4,0 Kg
- XL** 4,2 Kg



+



+



=

Max
100 Kg.



max
kg. ??

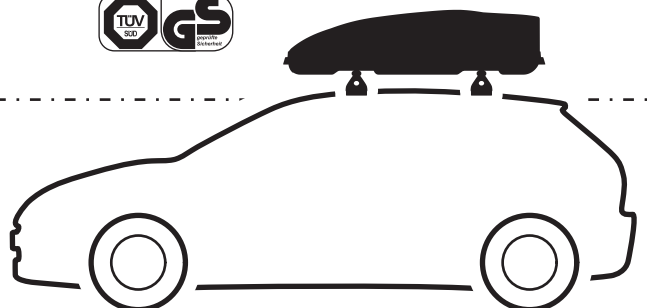

1



NORDRIVE QUADRA
Acciaio / Steel

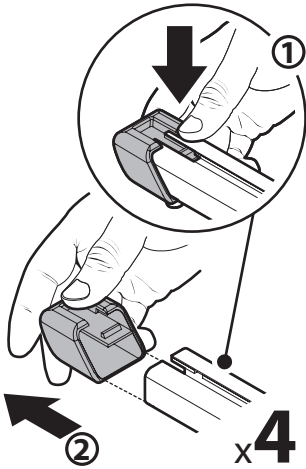

NORDRIVE ALUMIA
Alluminio / Aluminium

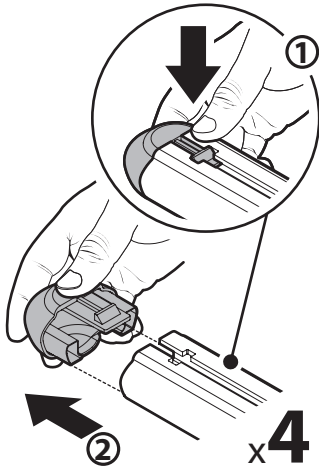

NORDRIVE HELIO
Alluminio / Aluminium

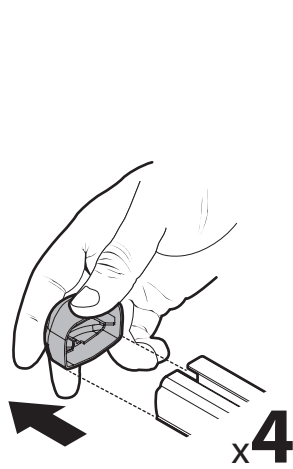

NORDRIVE SILENZIO
Alluminio / Aluminium

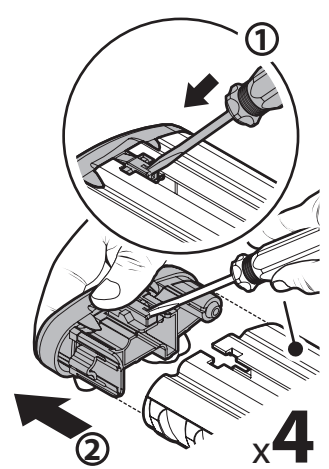

2

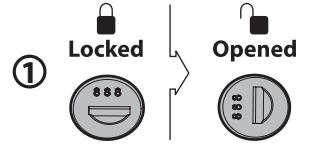
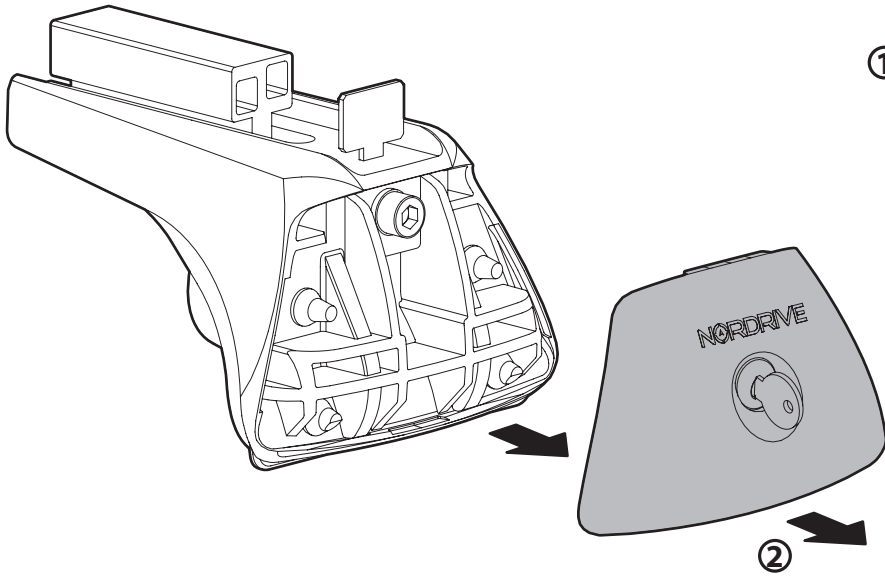

3

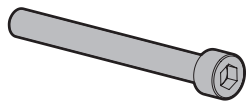
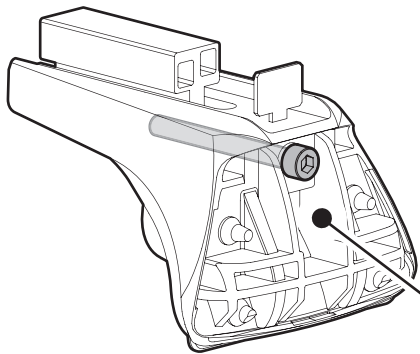

Vite / Screw / Schraube



Preassemblate
Pre-assembled
Vormontiert **> 80 mm**
M6x80
60CE6880

Include
Included
Inbegriffen **> 100 mm**
M6x100
60CE6900

	✓	✓	
		✓	✓

4

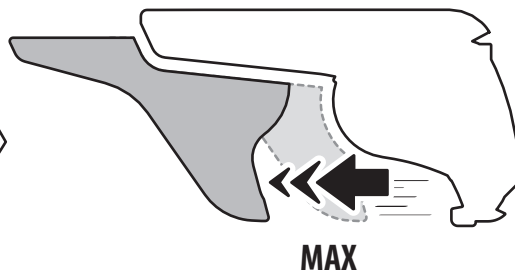
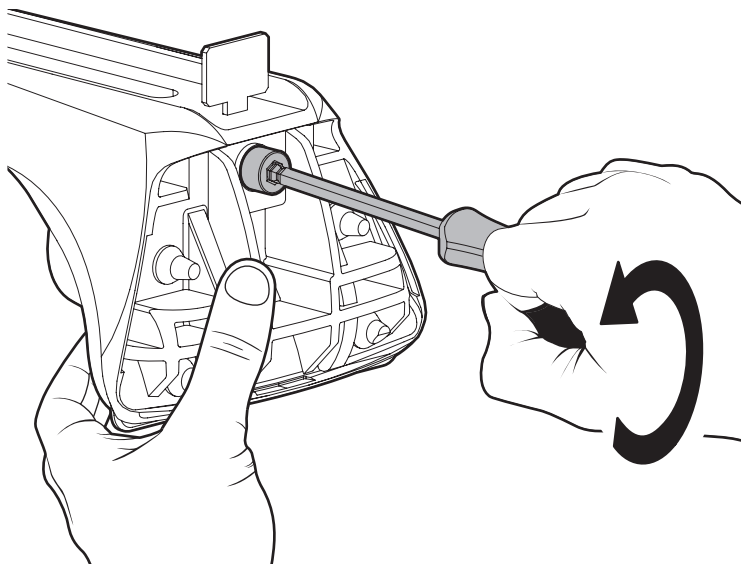

x4

5

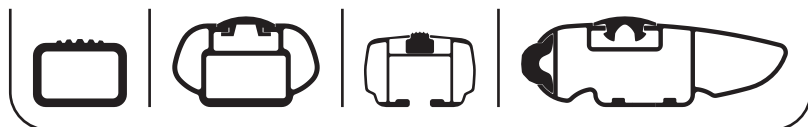
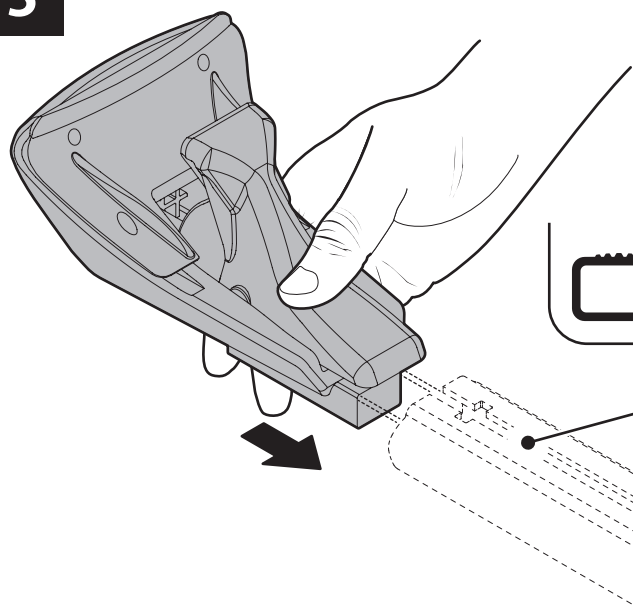

x4

6



NORDRIVE **QUADRA**
Acciaio / Steel

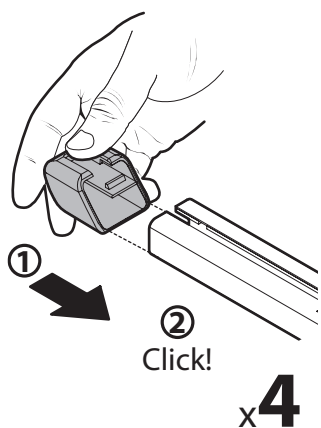

x4



NORDRIVE **ALUMIA**
Alluminio / Aluminium

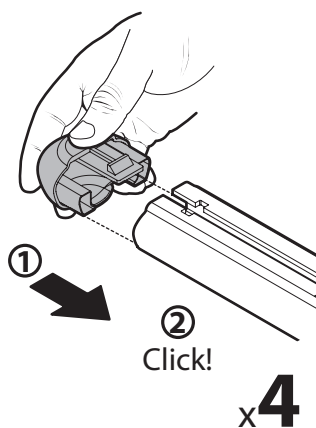

x4



NORDRIVE **HELIO**
Alluminio / Aluminium

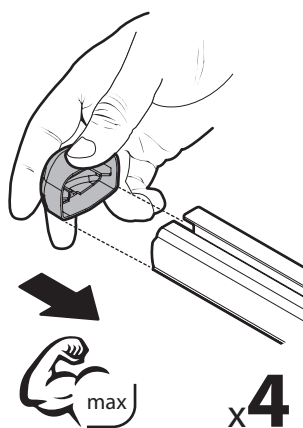

x4



NORDRIVE **SILENZIO**
Alluminio / Aluminium

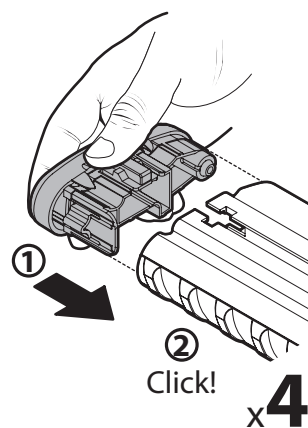

x4

7



8

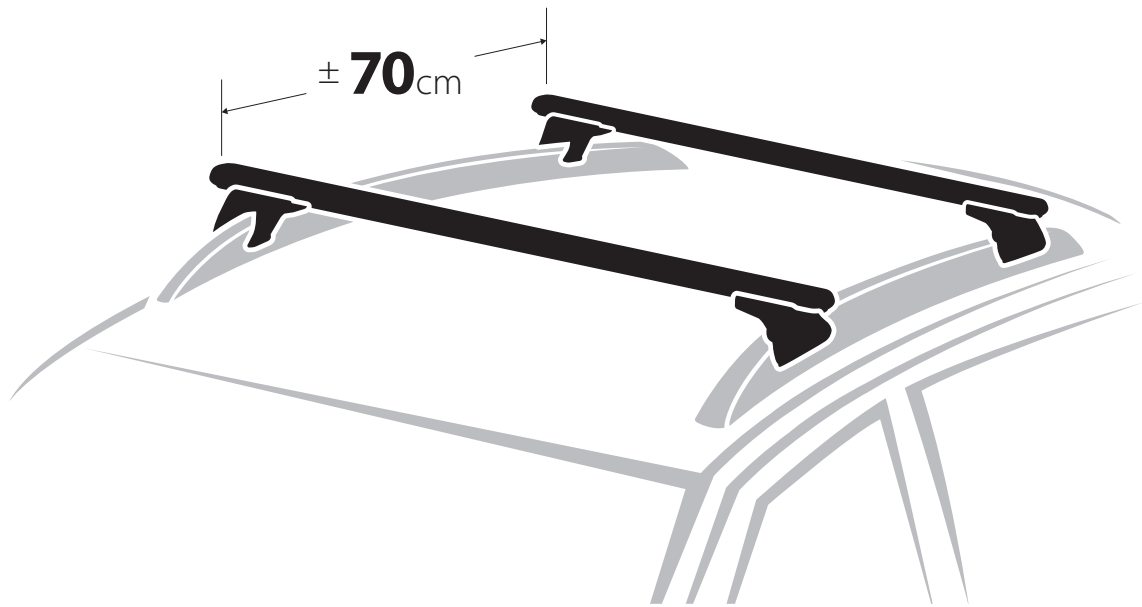

9

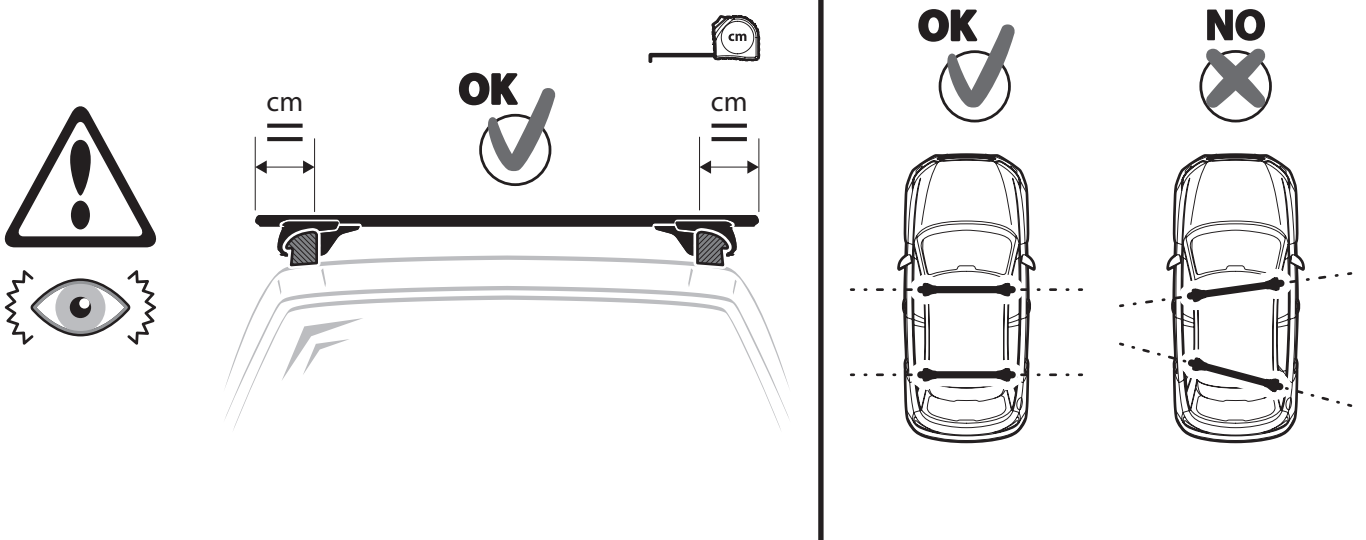

10

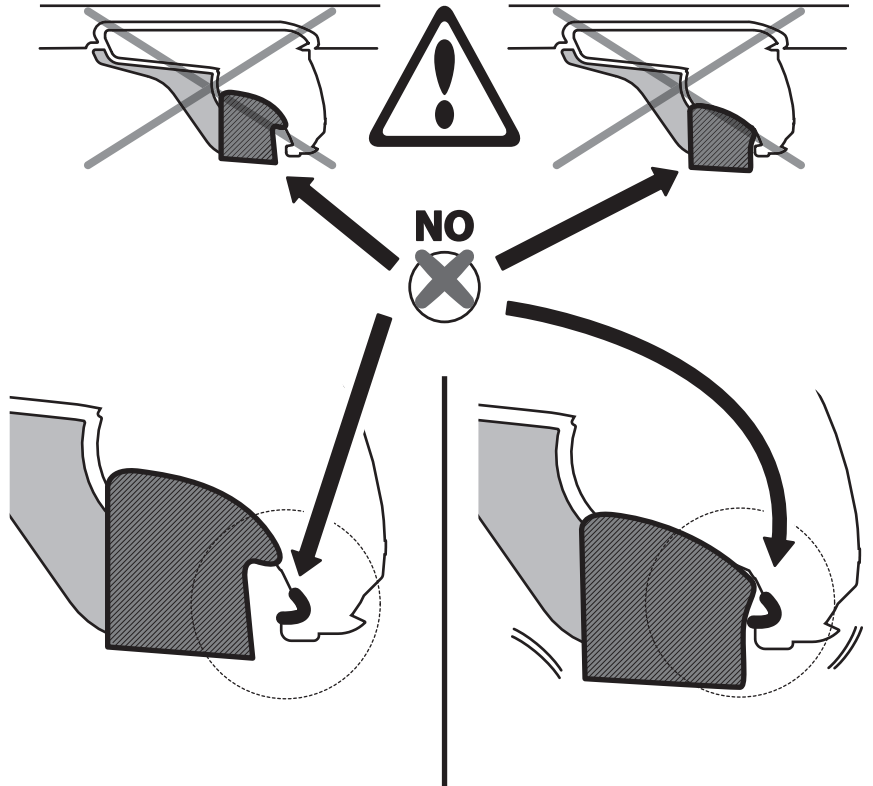
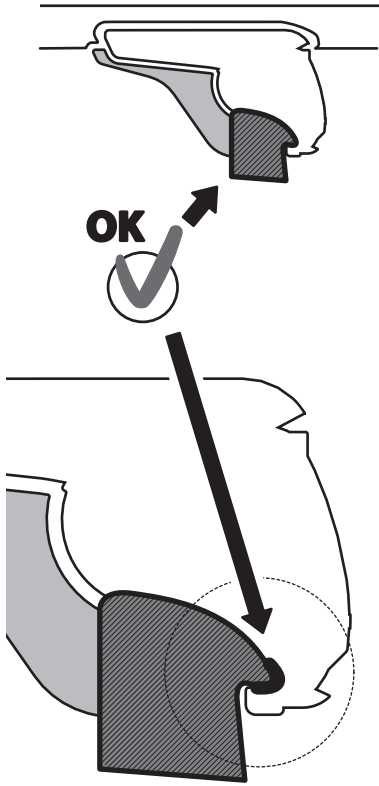
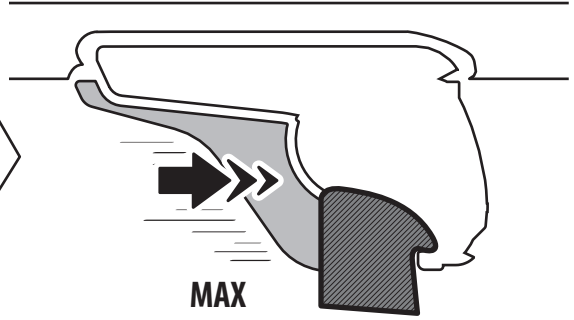
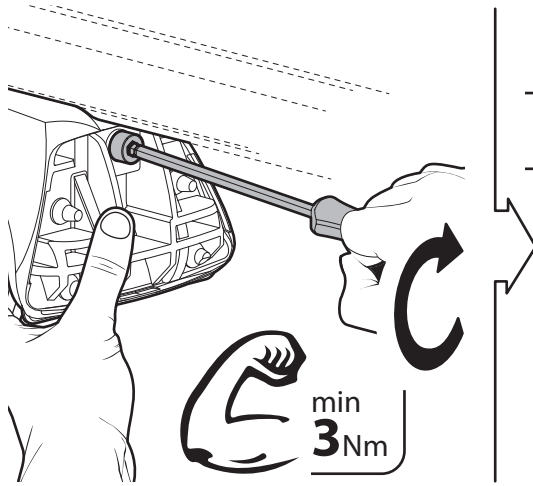
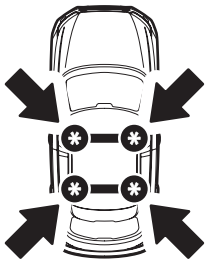

11

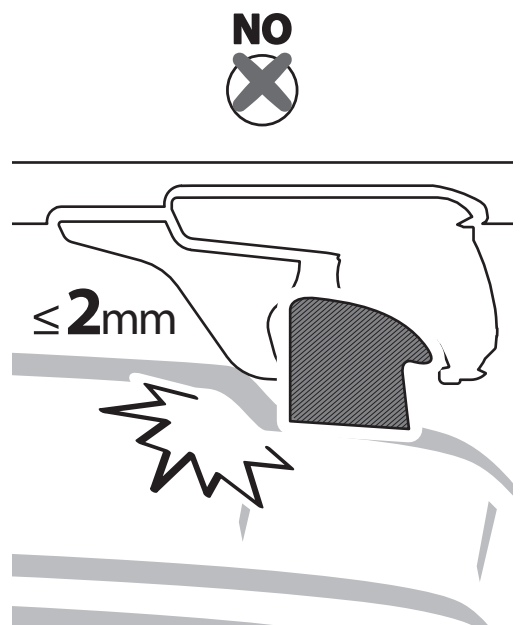
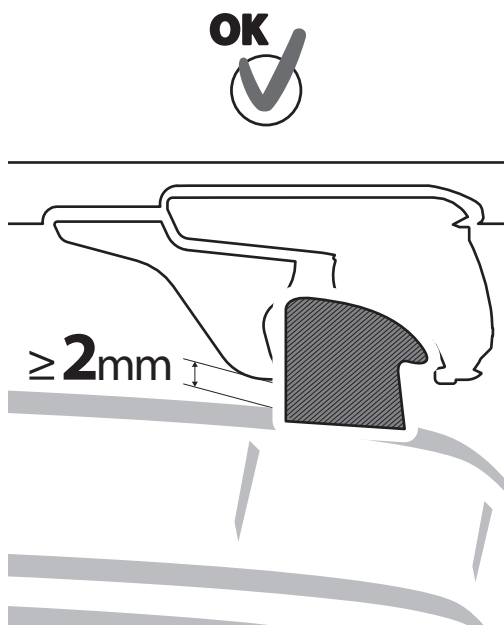

12

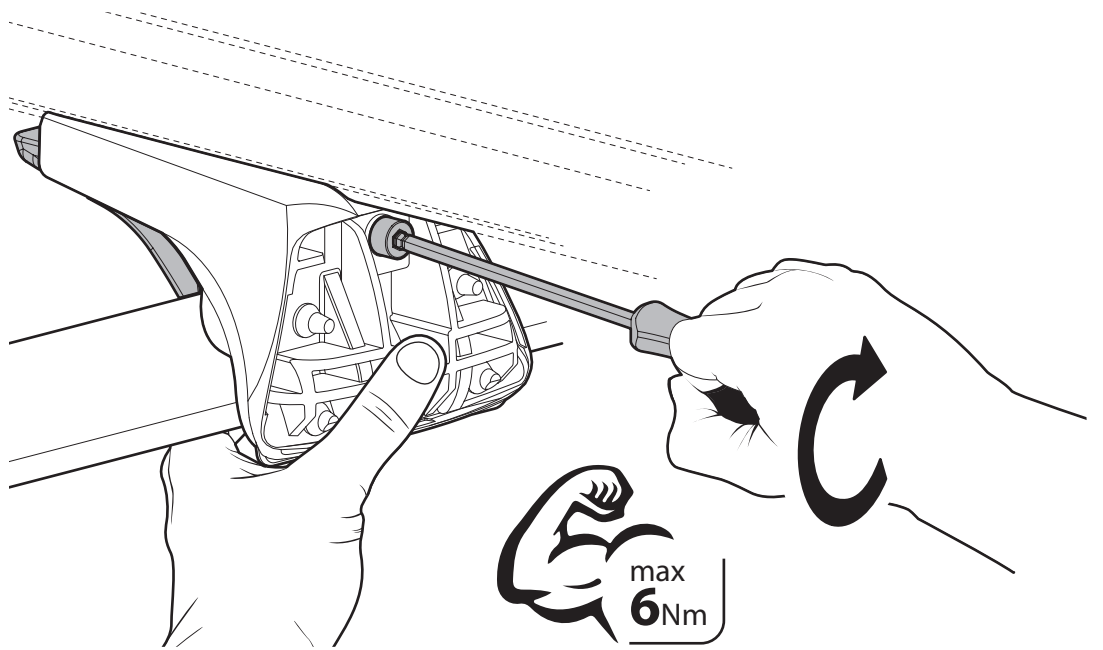
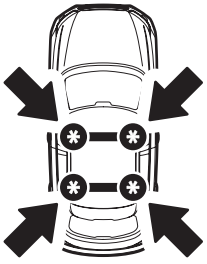

13

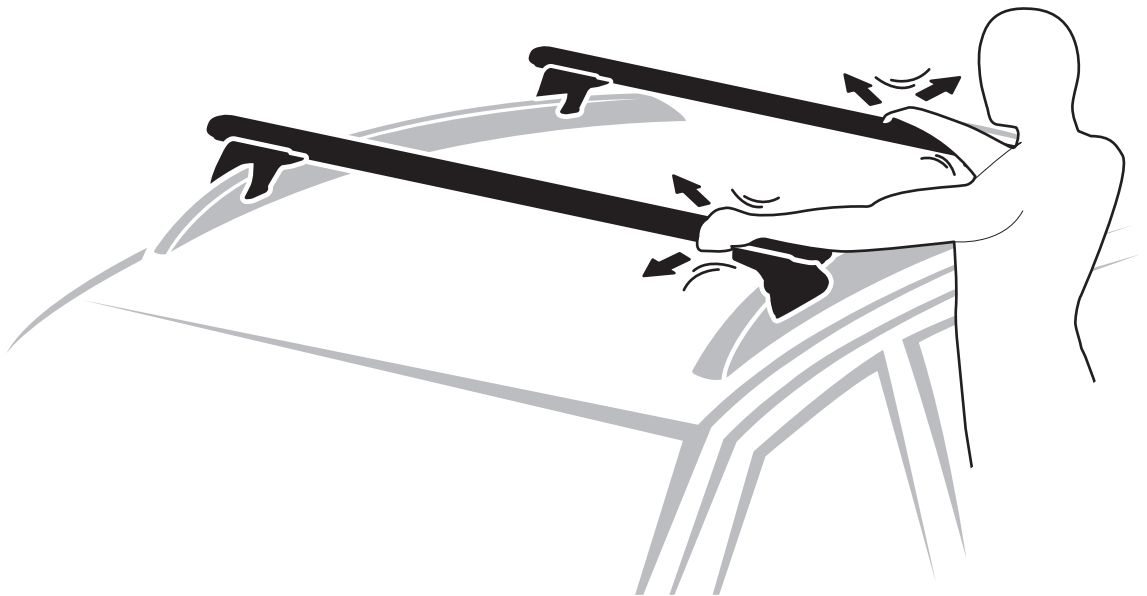

14

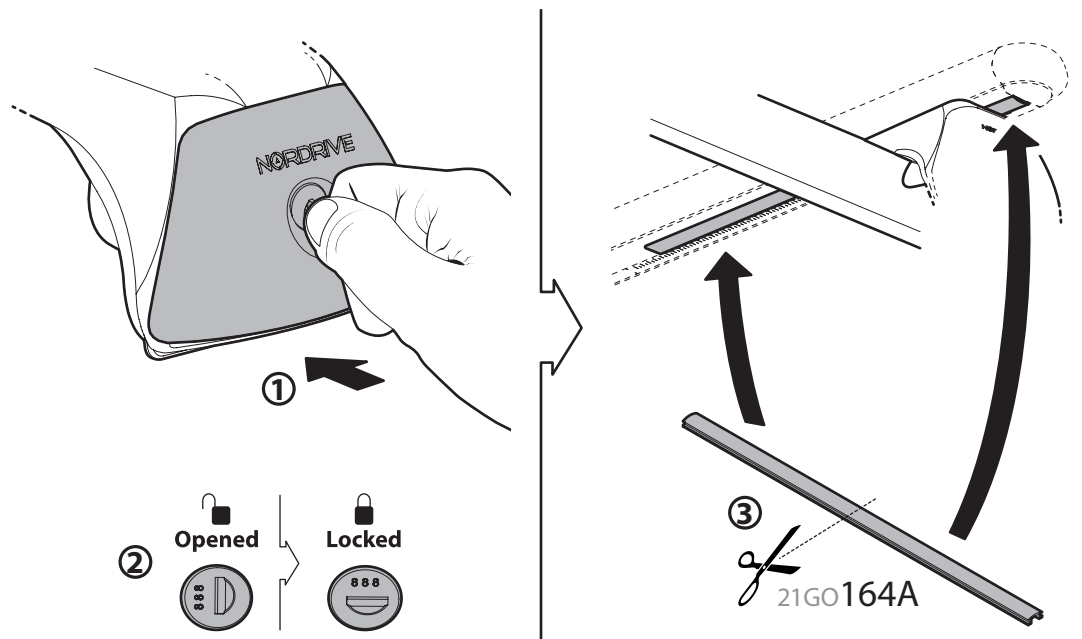
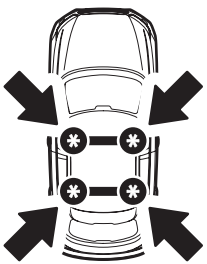



Attenzione • Warning • Attention • Hinweise • Advertencia

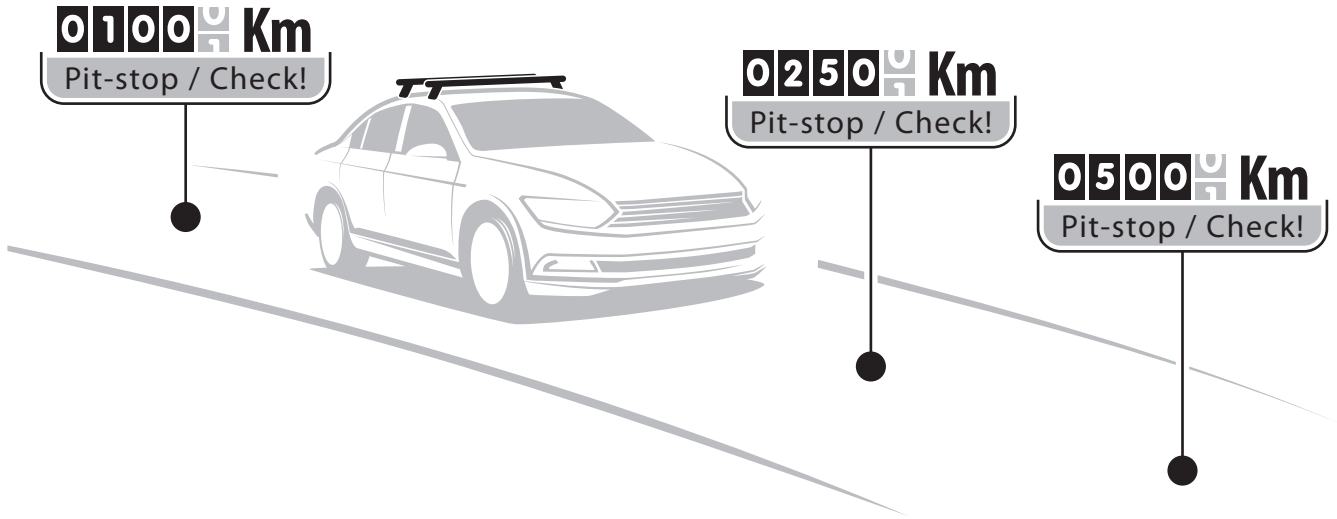

Pit-stop / Check!

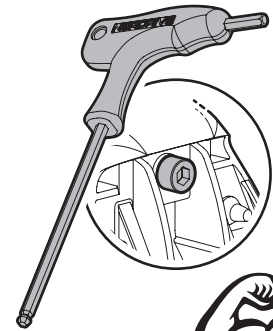
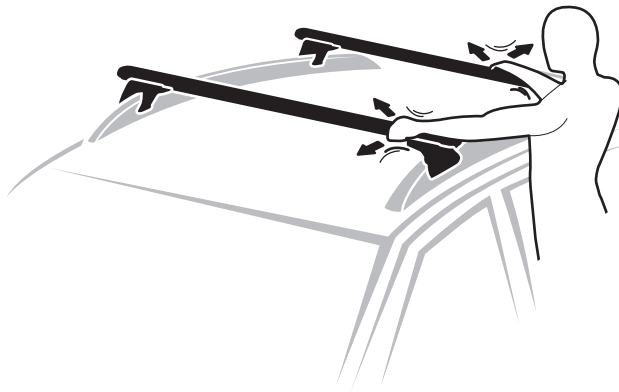

OK

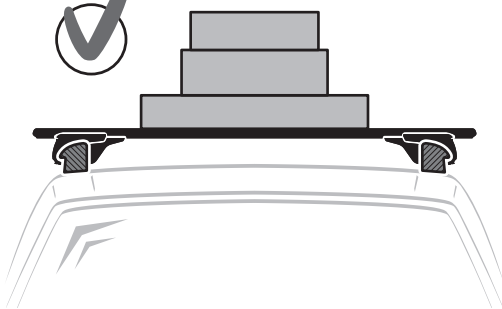

NO

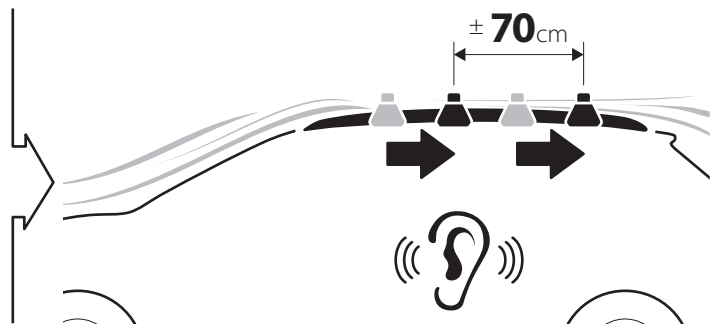
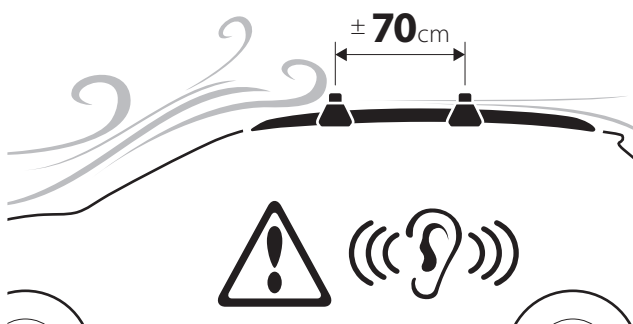
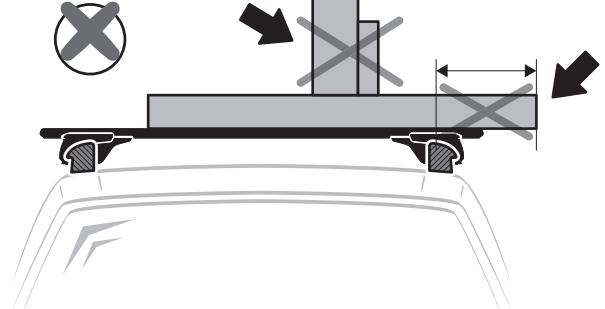



Attenzione • Warning • Attention • Hinweise • Advertencia

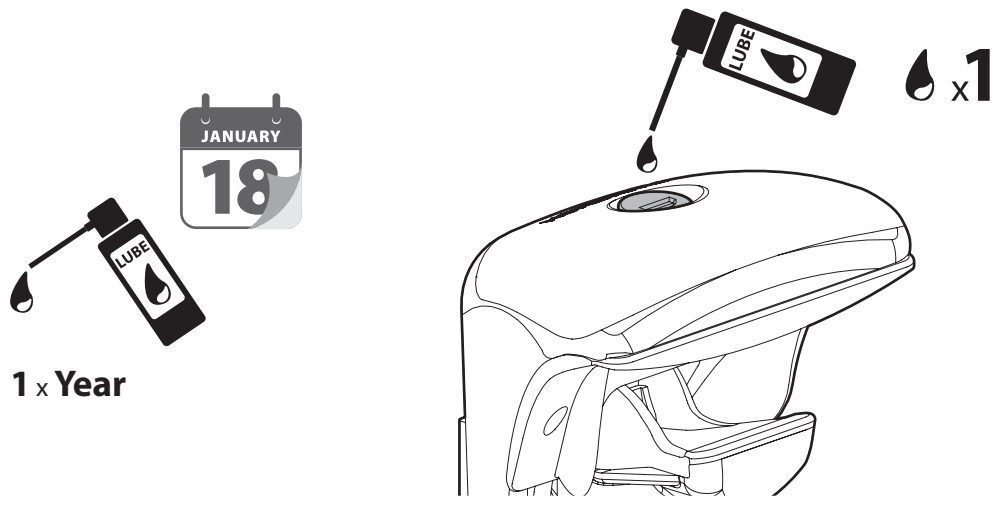
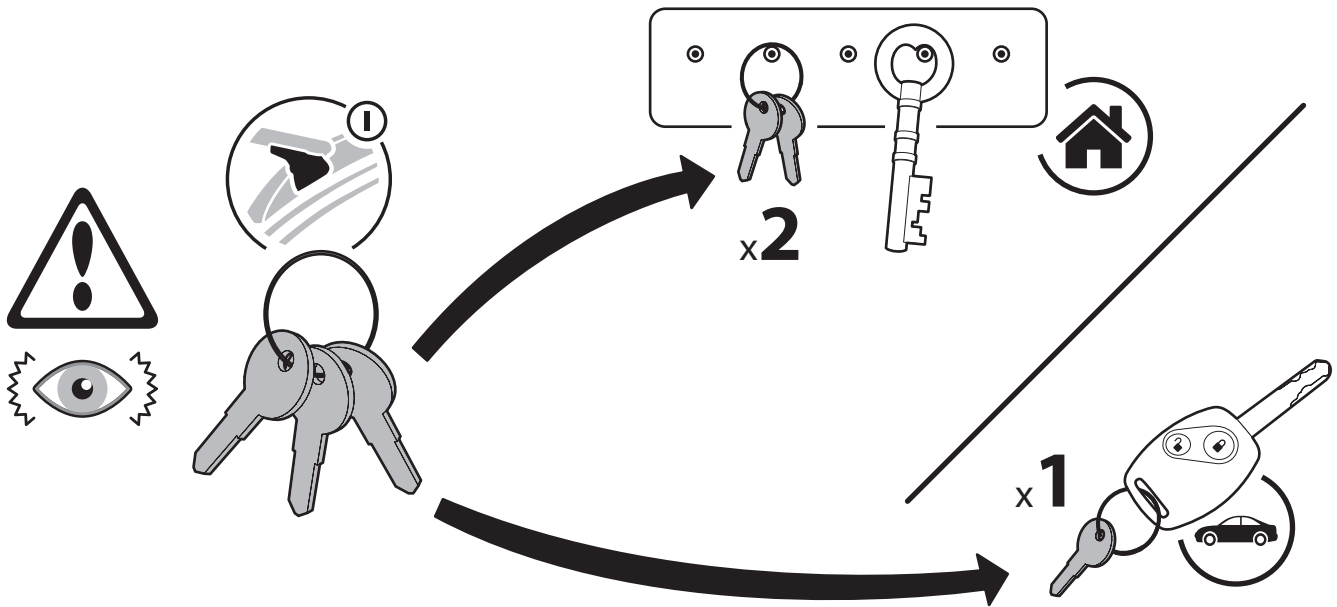

- (I) Lotto di produzione da comunicare per eventuali ricambi
- (GB) Production lot number to be communicated for any spare parts
- (F) Lot de production à communiquer pour toute pièce de rechange
- (D) Produktionscharge für eventuelle Ersatzteile
- (E) Lote de producción a comunicar por cualquier repuesto

Lot.

NORDRIVE®
TRANSPORT SOLUTIONS

**NORDRIVE® is a registered trademark of
LAMPA S.p.A.**

Via G. Rossa 53/55, 46019 Viadana (MN) ITALY
Tel. +39 0375 820700

UNI EN ISO 9001 / ISO 14001 / ISO 45001 Certified Company
service@lampa.it

www.nordrive.it www.lampa.it