

Art. **N30013**

CITROËN BERLINGO

2000
05/96→03/08

PEUGEOT PARTNER

2000
05/96→03/08

PEUGEOT RANCH

2000
05/96→03/08

KIT x6

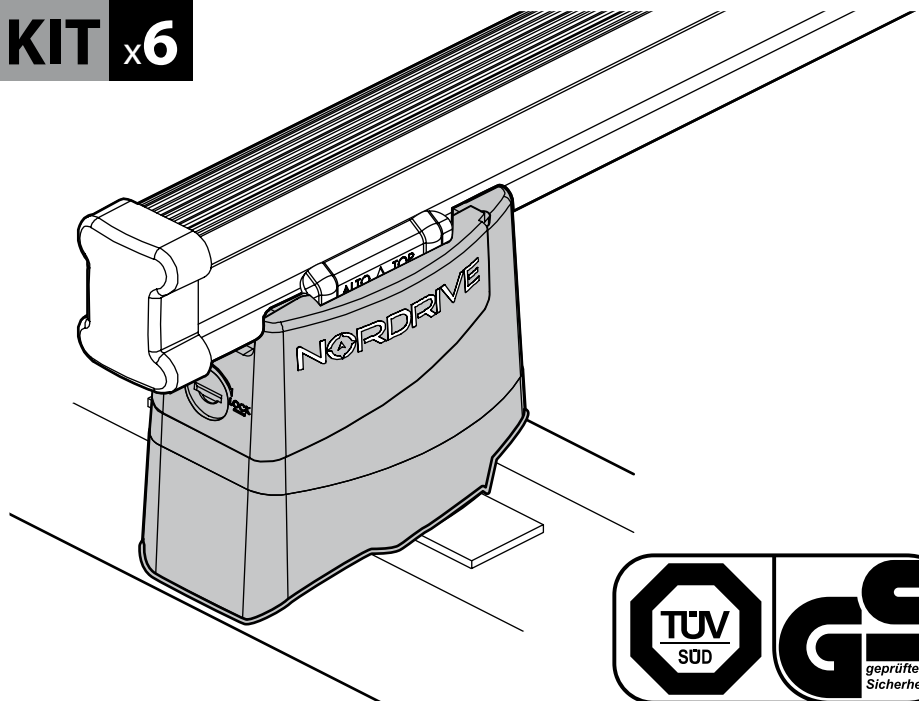

- ⓐ ADATTO PER
- ⓑ SUITABLE FOR
- ⓒ INDIQUÉ POUR
- ⓓ GEEIGNET FÜR
- ⓔ ADECUADA PARA

NORDRIVE
KARGO SERIES

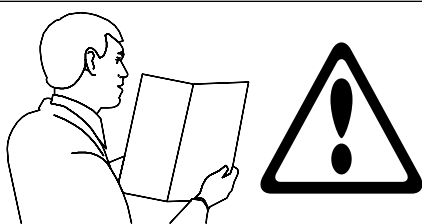

- ⓐ ISTRUZIONI DI MONTAGGIO
- ⓑ FITTING INSTRUCTIONS
- ⓓ MONTAGEANLEITUNG
- ⓔ INSTRUCTIONS DE MONTAGE
- ⓕ ISTRUCCIONES DE MONTAJE
- ⓖ INSTRUÇÕES DE MONTAGEM
- ⓗ MONTAGE-INSTRUCTIES
- ⓓ MONTERINGSANVISNING
- ⓔ ASENUSOHJE
- ⓕ PAIGALDUSJUHEND
- ⓖ STIPRINĀŠANAS INSTRUKCIJA
- ⓗ PRITVIRTINIMO INSTRUKCIJOS
- ⓓ INSTRUKCJA MONTAŻU
- ⓔ Инструкции по установке
- ⓕ NÁVOD NA MONTÁŽ
- ⓖ NÁVOD NA MONTÁŽ
- ⓗ NAVODILA ZA PRITRJEVANJE
- ⓓ UPUTA ZA SASTAVLJANJE
- ⓔ A FELSZERELÉS MÓDJA
- ⓖ Οδηγίες συναρμολόγησης
- ⓗ MONTAJ TALIMATLARL
- ⓔ ИНСТРУКЦИИ ЗА МОНТАЖ
- ⓕ UPUTSTVA ZA MONTAŽU

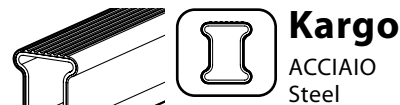

Kargo
ACCIAIO
Steel

- ⓐ BARRE KARGO
- ⓑ KARGO BARS
- ⓒ BARRES KARGO
- ⓓ DACH-LASTENTRÄGER KARGO
- ⓔ BARRES KARGO

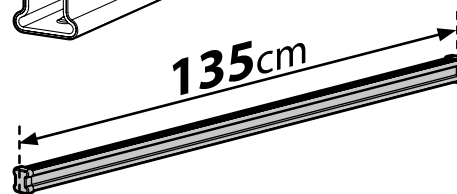

Kargo-Plus
ALLUMINIO
Aluminium

- ⓐ BARRE KARGO-PLUS
- ⓑ KARGO-PLUS BARS
- ⓒ BARRES KARGO-PLUS
- ⓓ DACH-LASTENTRÄGER KARGO-PLUS
- ⓔ BARRES KARGO-PLUS

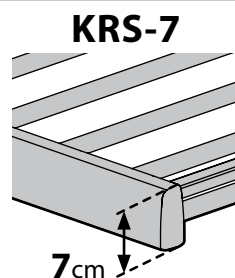

KRS-7

7cm

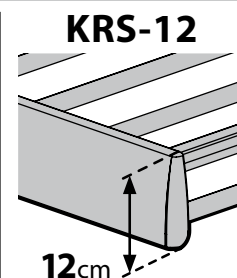

KRS-12

12cm

- ⓐ CESTE PORTATUTTO KRS-7 / KRS-12
- ⓑ KRS-7 / KRS-12 VAN ROOF RACKS
- ⓒ GALERIE KRS-7 / KRS-12
- ⓓ DACHKÖRBEIN KRS-7 / KRS-12
- ⓔ BACAS KRS-7 / KRS-12

NORDRIVE[®]

TRANSPORT SOLUTIONS

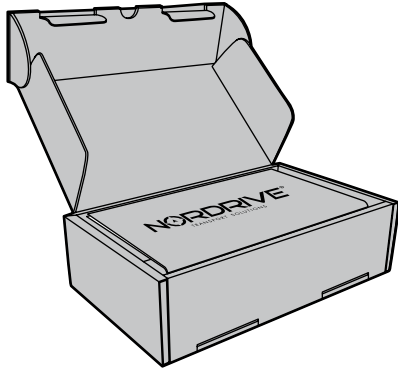

NORDRIVE®

TRANSPORT SOLUTIONS

Art. **N30013**

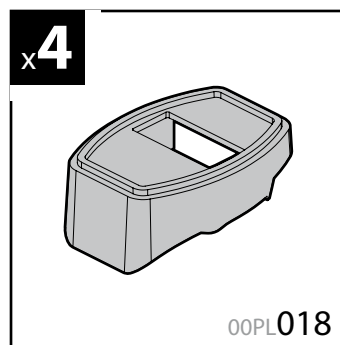
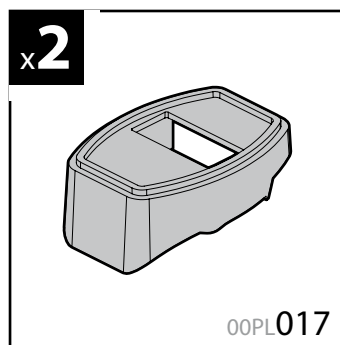
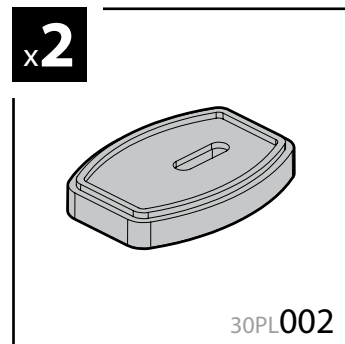
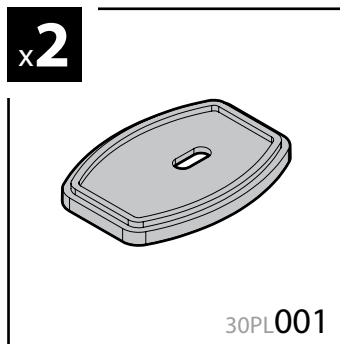
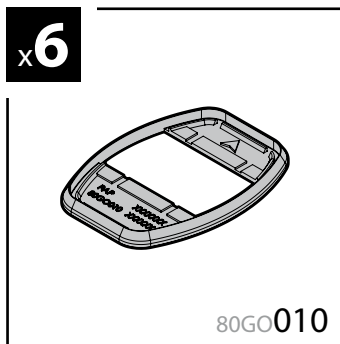
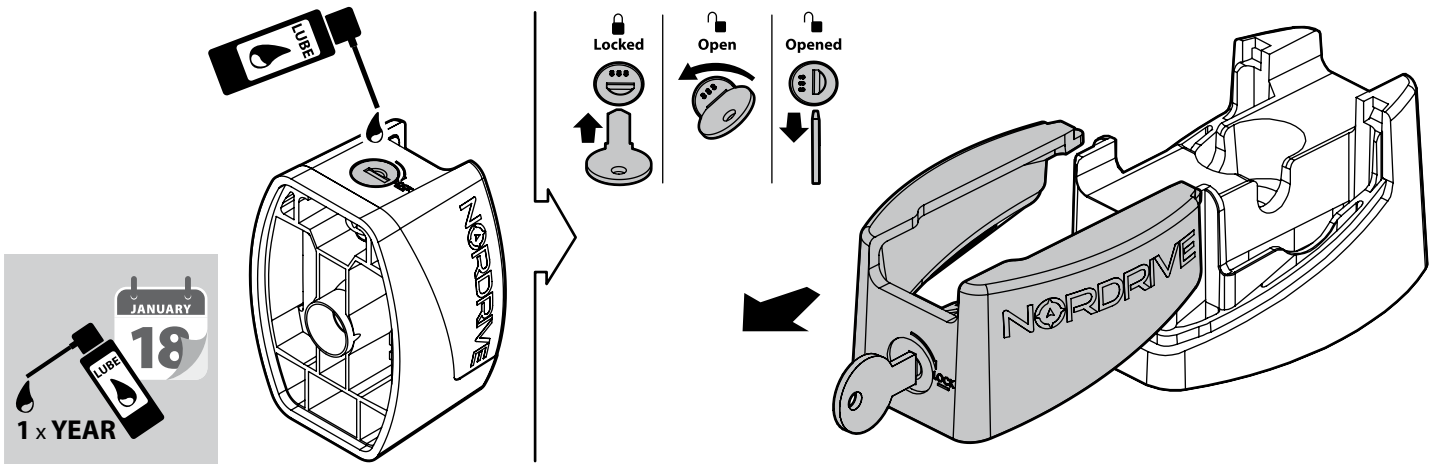
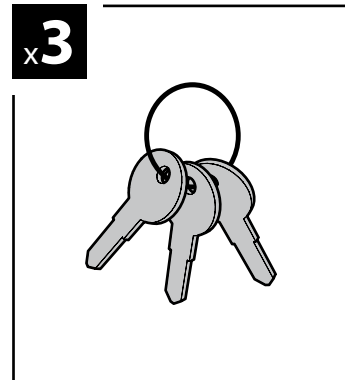
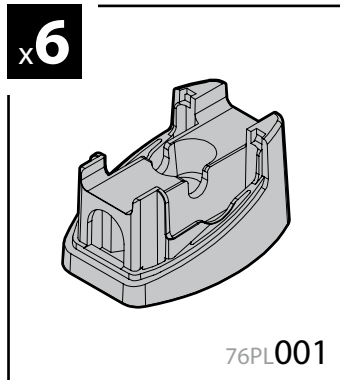
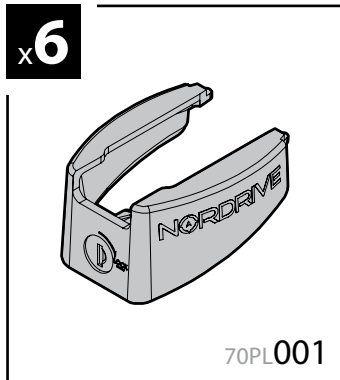

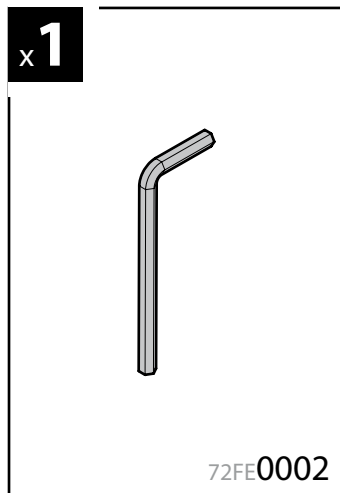
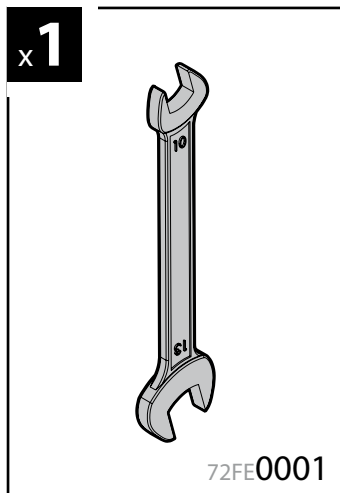
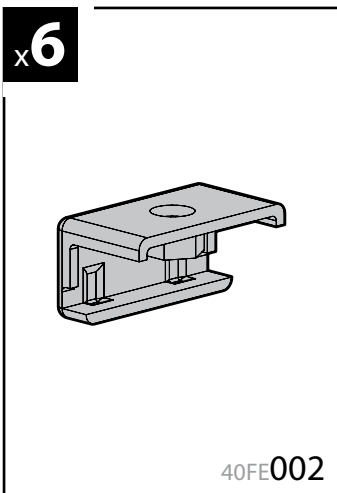
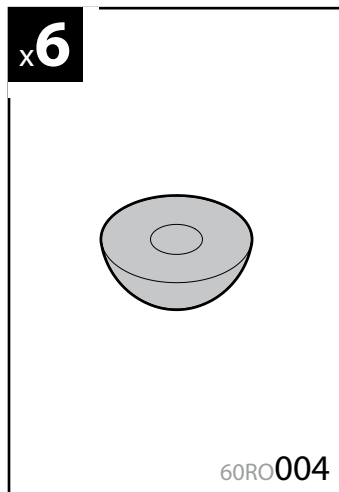
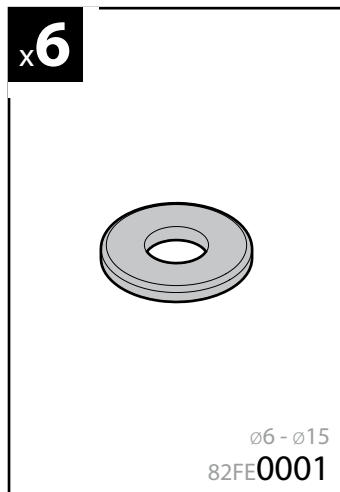
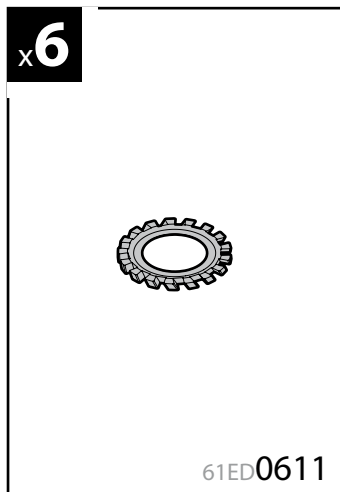
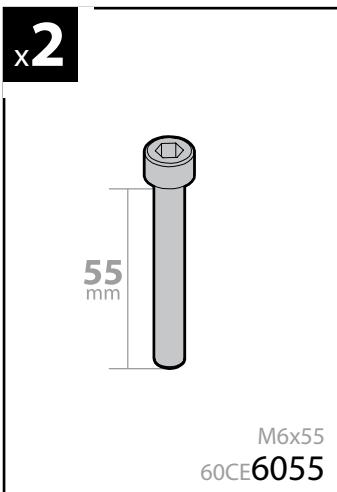
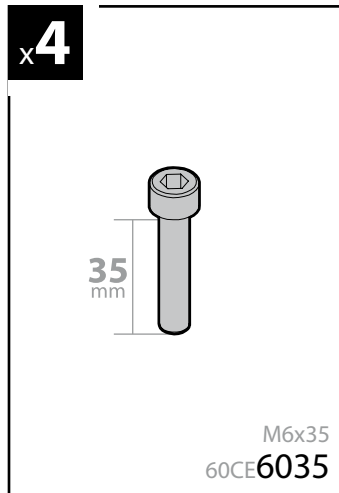
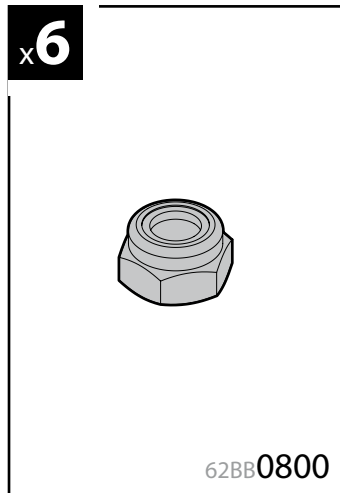
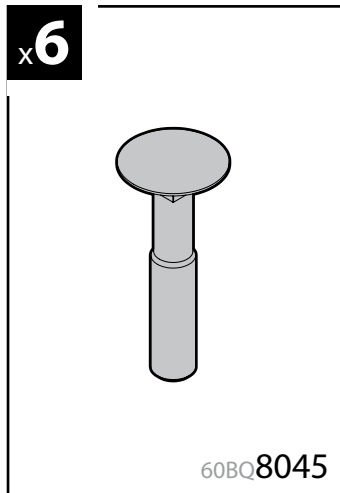
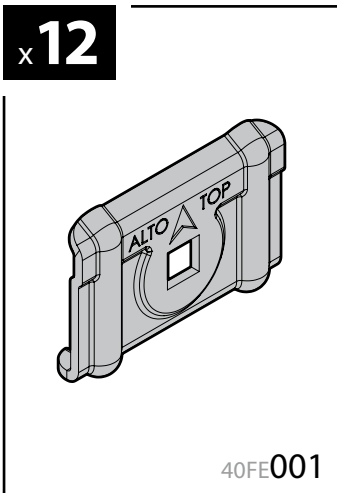

(I) ISTRUZIONI DI MONTAGGIO
 (GB) FITTING INSTRUCTIONS
 (D) MONTAGEANLEITUNG
 (F) INSTRUCTIONS DE MONTAGE
 (E) INSTRUCCIONES DE MONTAJE
 (P) INSTRUÇÕES DE MONTAGEM
 (NL) MONTAGE-INSTRUCTIES
 (S) MONTERINGSANVISNING

(FIN) ASENNUSOHJE
 (EST) PAIGALDUSJUHEND
 (LAT) STIPRINĀŠANAS INSTRUKCIJA
 (LT) PRITVIRTINIMO INSTRUKCIJOS
 (PL) INSTRUKCJA MONTAŻU
 (RUS) Инструкции по установке
 (CZ) NÁVOD NA MONTÁŽ
 (SK) NÁVOD NA MONTÁŽ

(SLO) NAVODILA ZA PRITRJEVANJE
 (HR) UPUTA ZA SASTAVLJANJE
 (H) A FELSZERELÉS MÓDJA
 (GR) Οδηγίες συναρμολόγησης
 (TR) MONTAJ TALIMATLARL
 (BG) ИНСТРУКЦИИ ЗА МОНТАЖ
 (SRB) UPUTSTVA ZA MONTAŽU

1

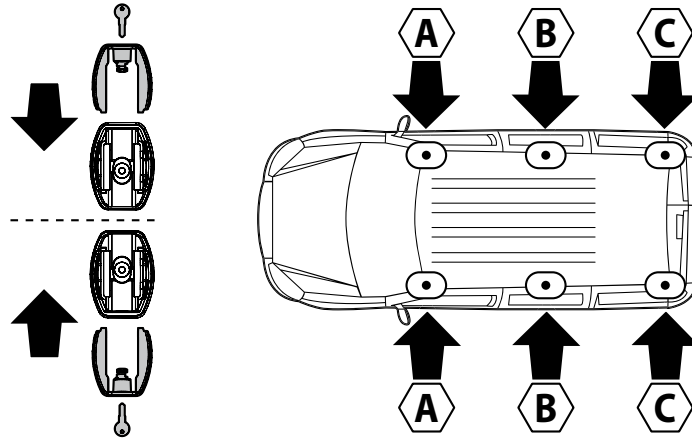

2

A

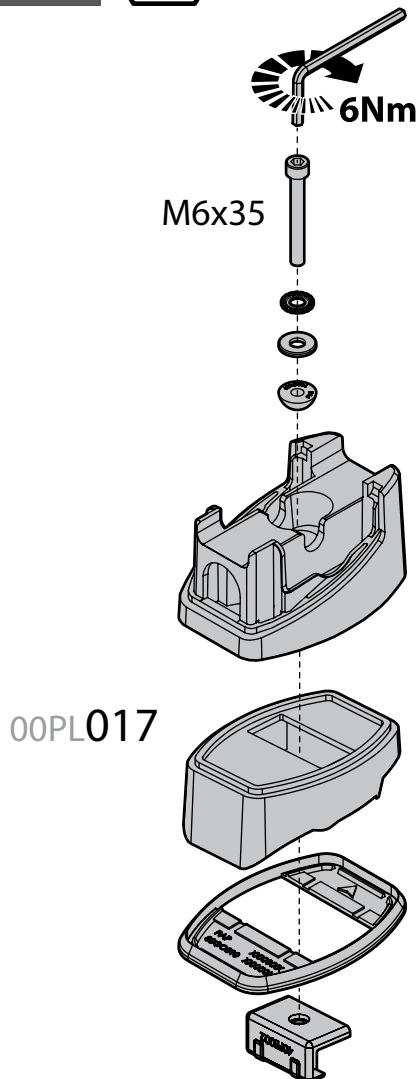

2

B

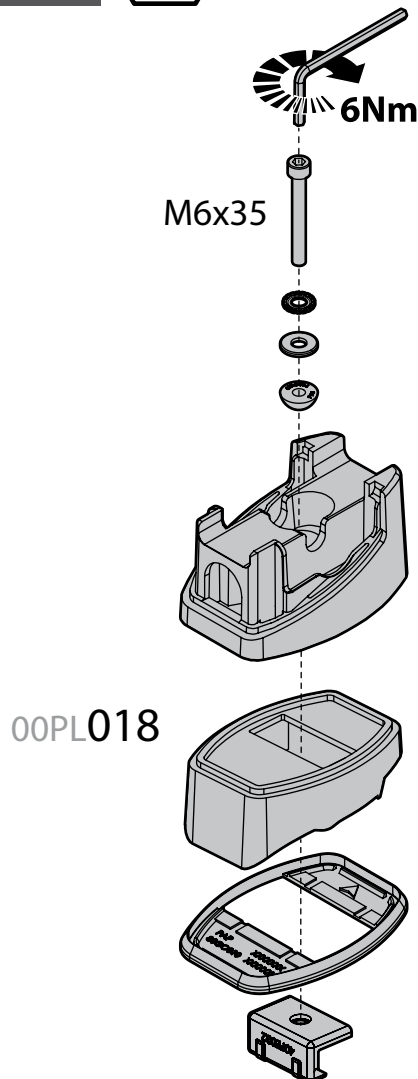

2

C

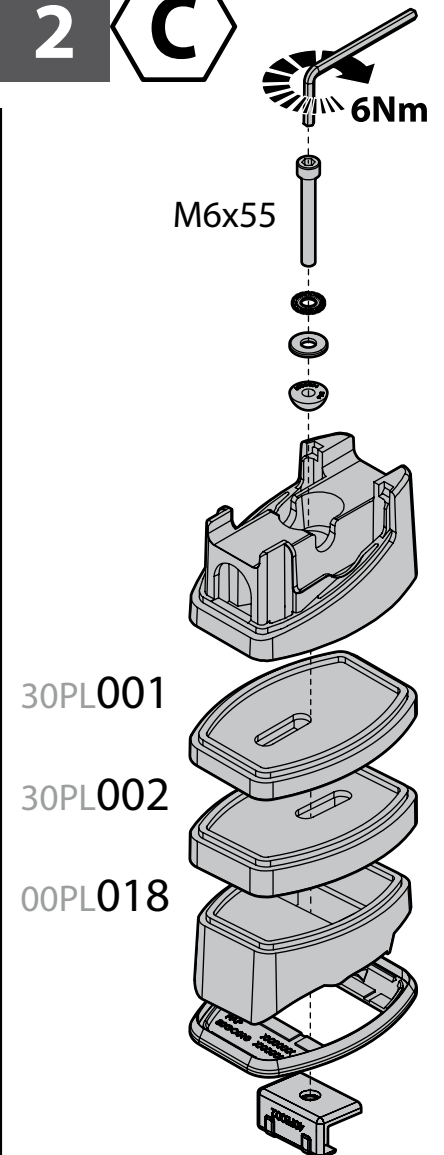

3

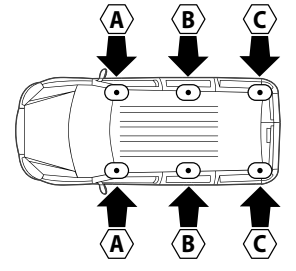
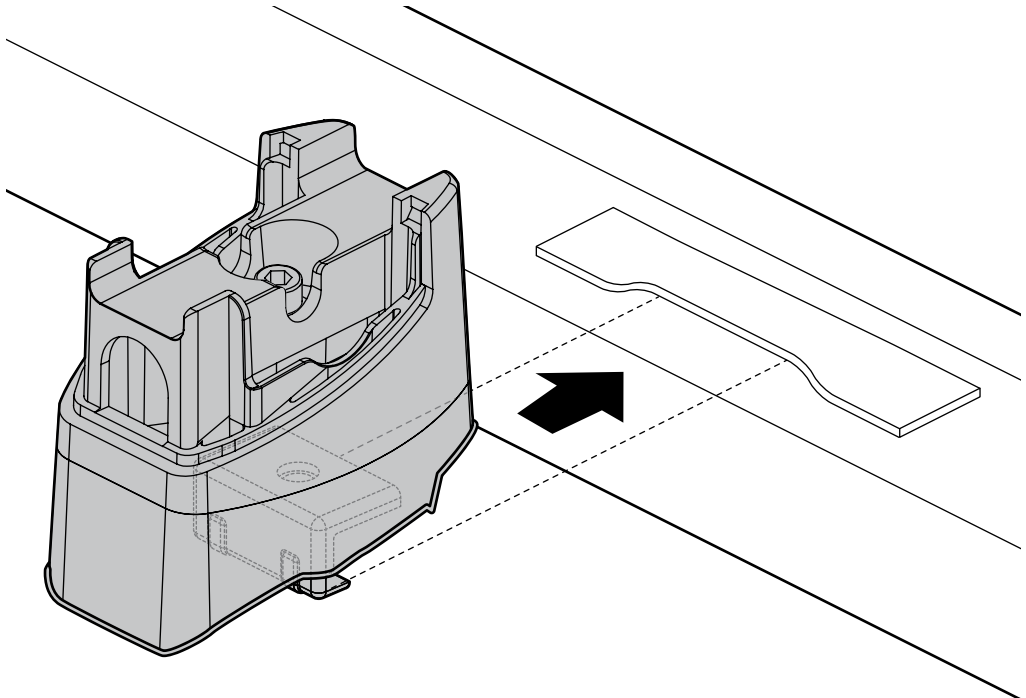
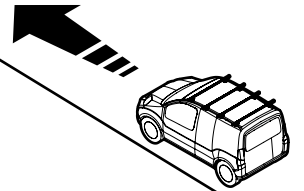

4

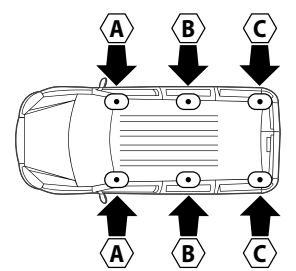
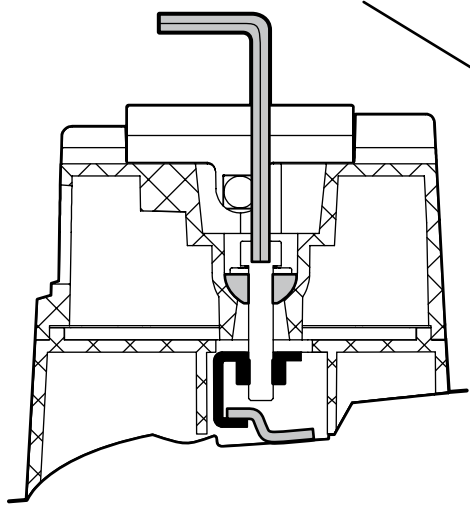
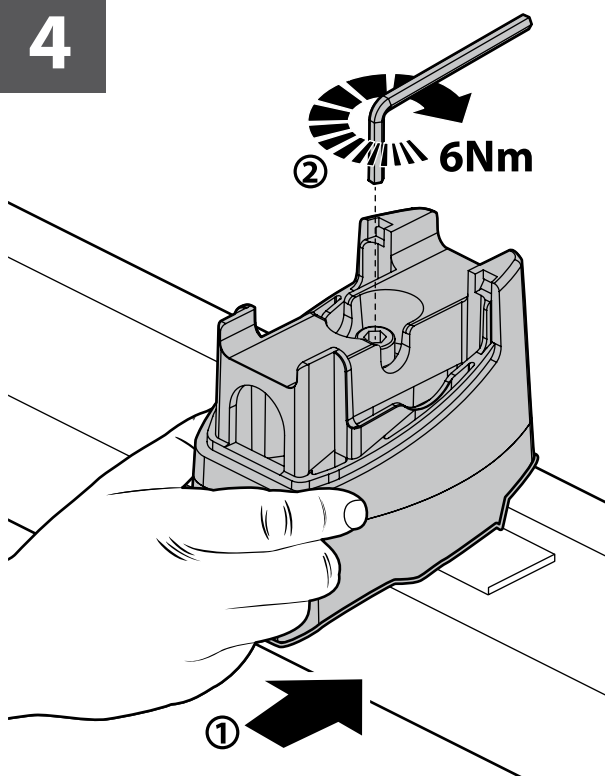
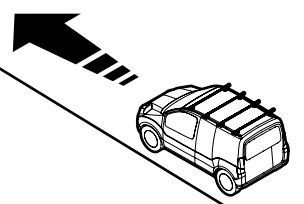



ATTENZIONE WARNING



A Kargo

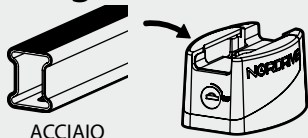

ACCIAIO
Steel

MONTAGGIO DIRETTO
SUI KIT PIEDI SPECIFICI
DIRECTLY ON FOOT KITS
BEFESTIGUNGSFÜSSE

A

B Kargo-Plus

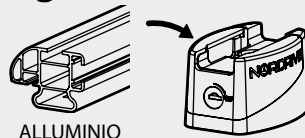

ALLUMINIO
Aluminium

MONTAGGIO DIRETTO
SUI KIT PIEDI SPECIFICI
DIRECTLY ON FOOT KITS
BEFESTIGUNGSFÜSSE

B

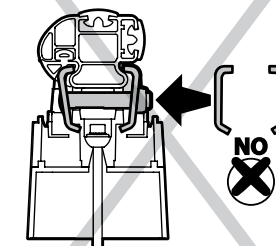
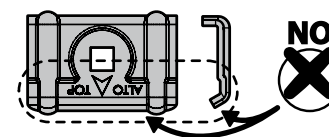
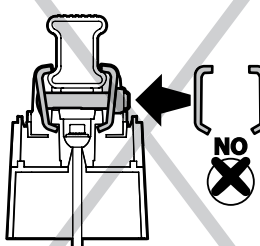
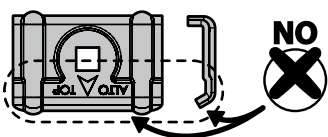
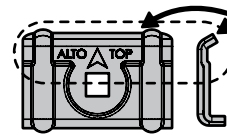
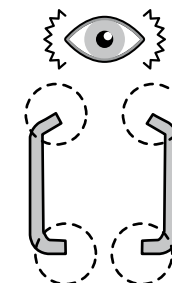
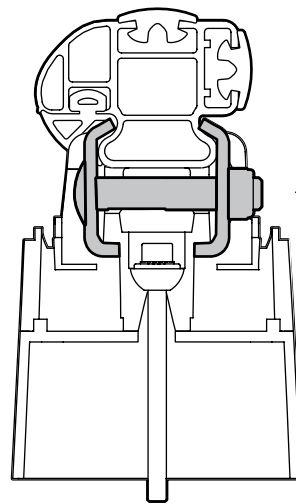
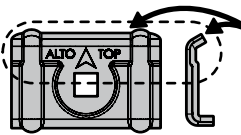
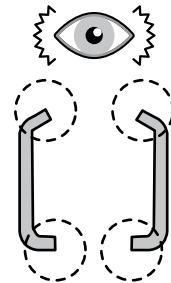
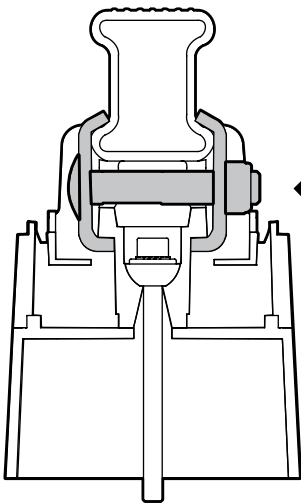
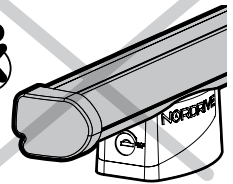
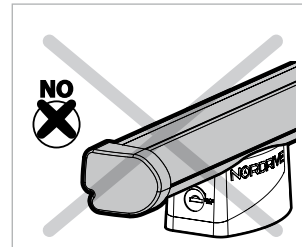
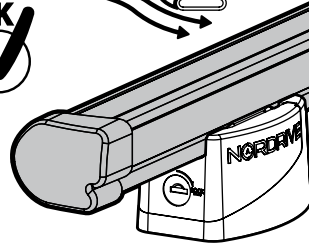
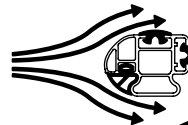
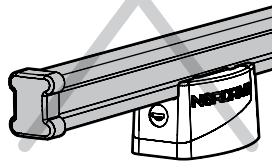
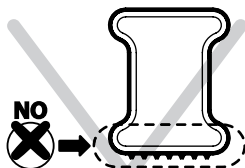
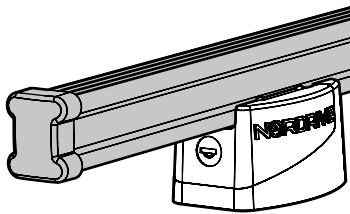
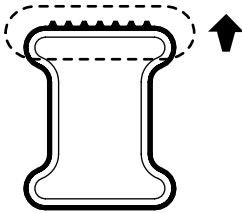

5

A

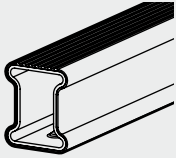

Kargo
ACCIAIO
Steel

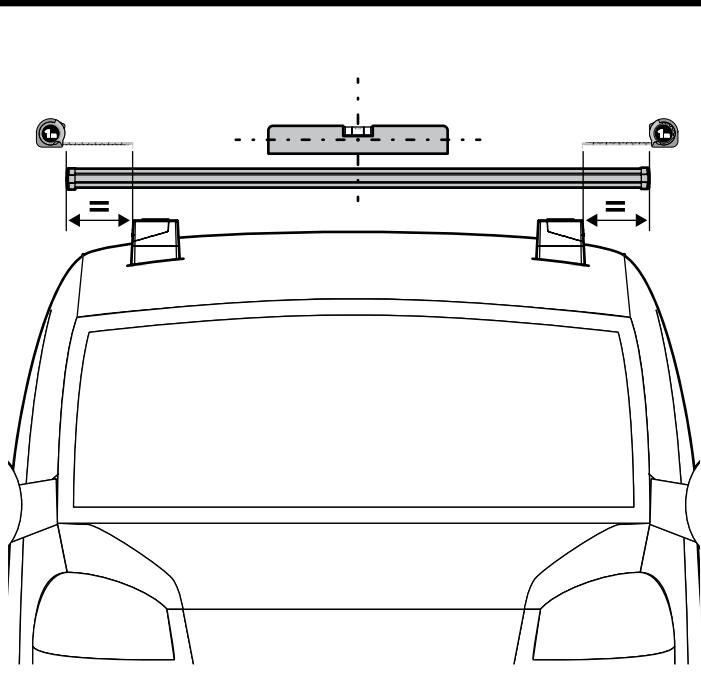
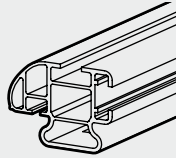

Diagram showing the installation of the Kargo steel bar on a car roof. The bar is shown being placed over the roof rails. The diagram includes dimension lines and arrows indicating the correct placement and alignment of the bar.

B



Kargo-Plus
ALLUMINIO
Aluminium

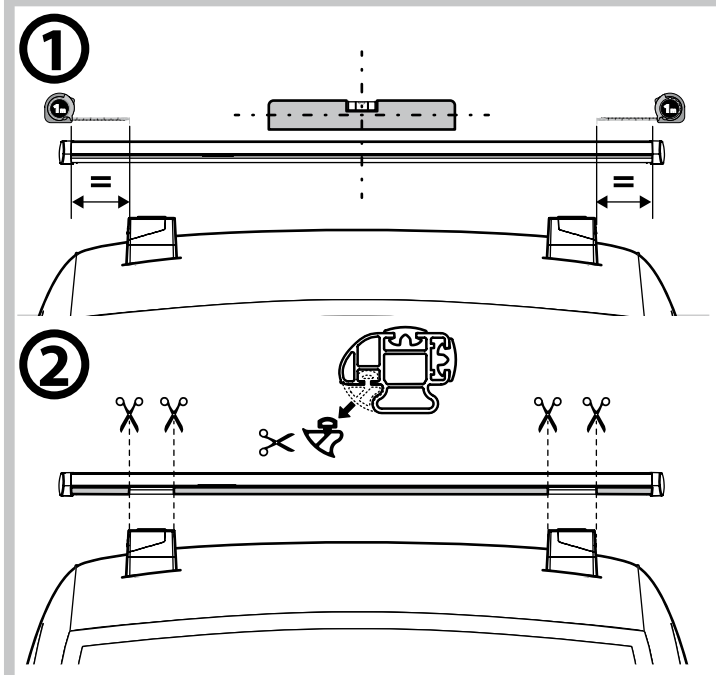

Diagram showing the installation of the Kargo-Plus aluminium bar on a car roof. It includes two steps: **1** shows the bar being placed over the roof rails, and **2** shows the bar being secured with clips. The diagram includes dimension lines and arrows indicating the correct placement and alignment of the bar.

6

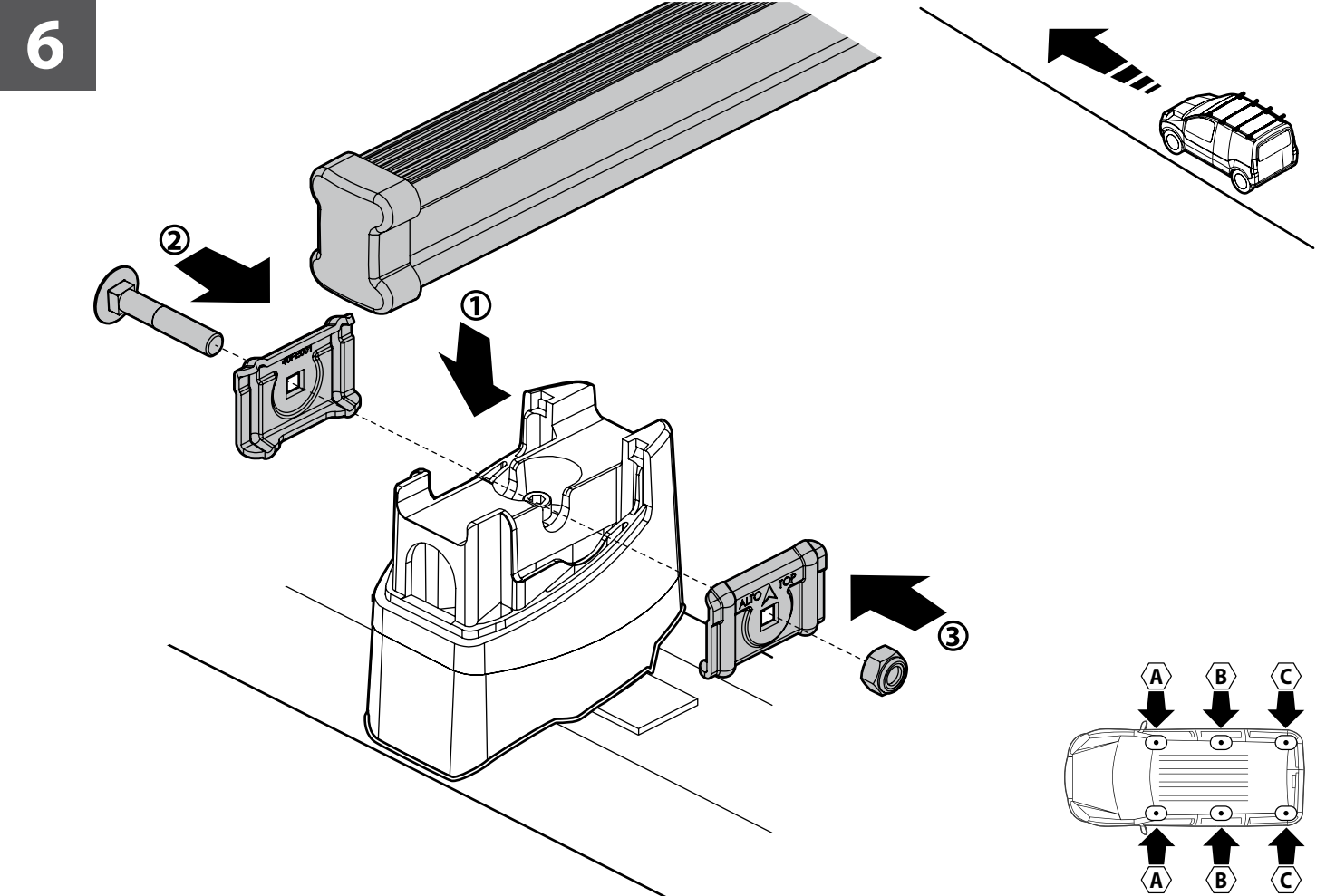
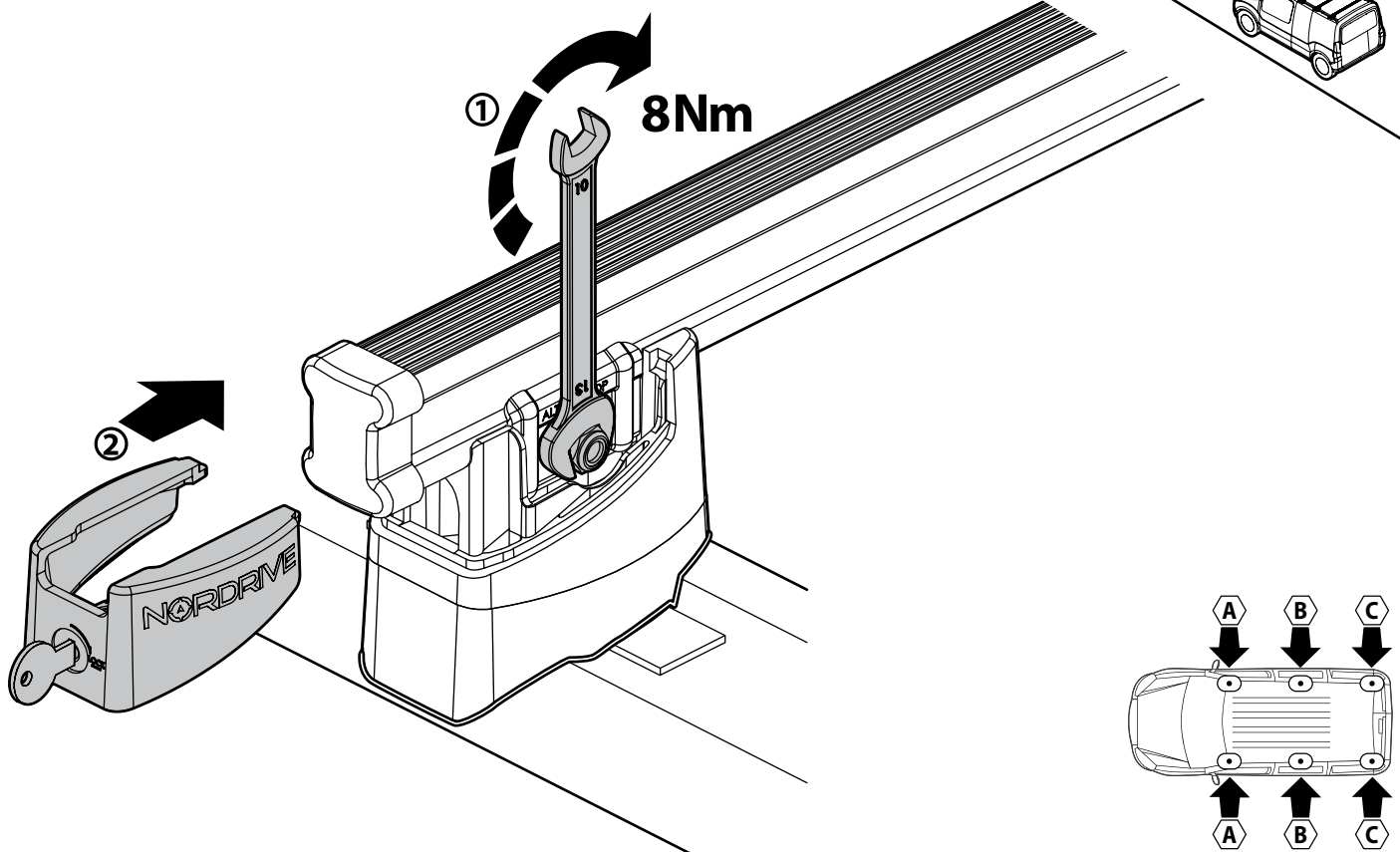
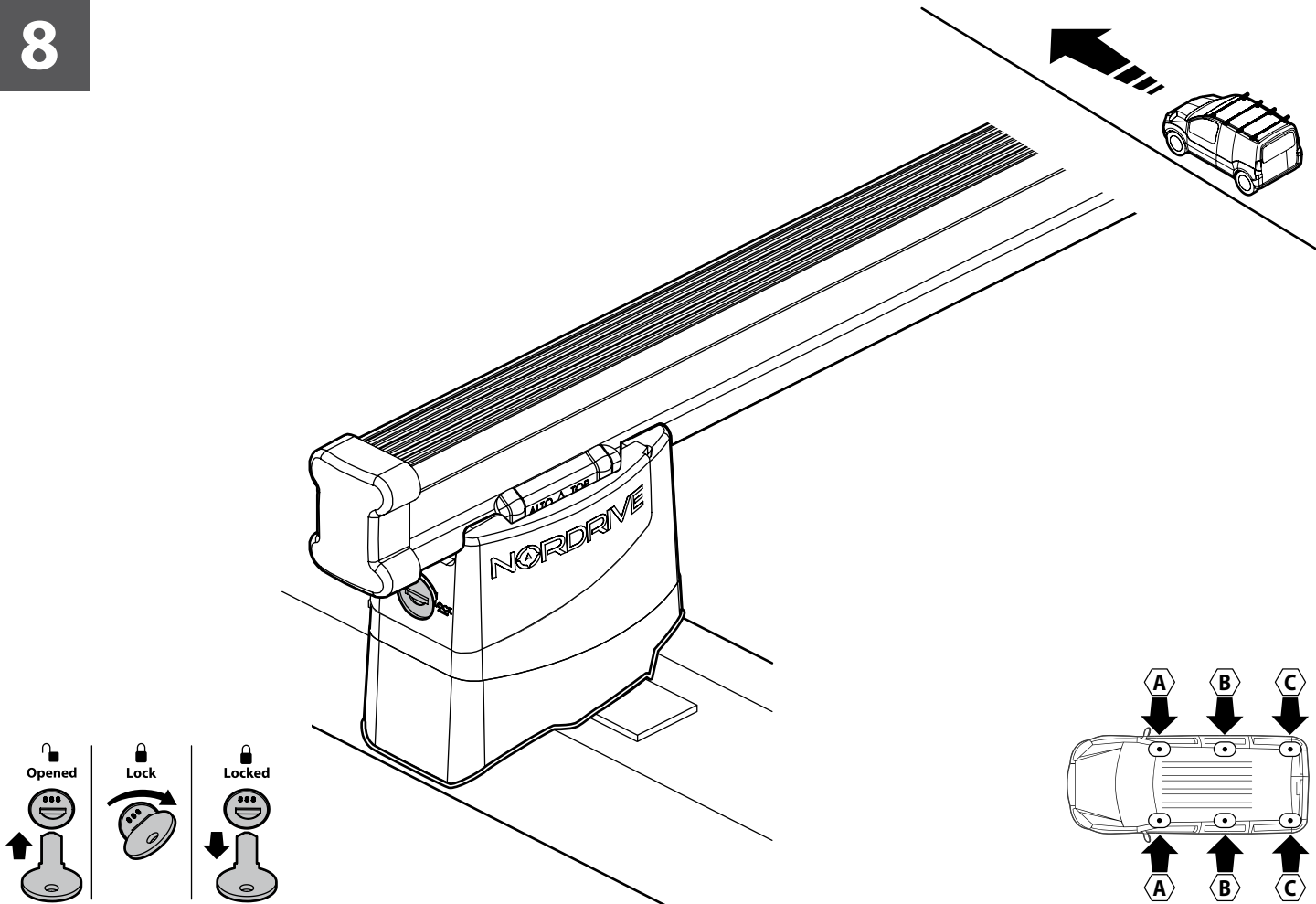

Diagram showing the assembly of the Kargo bar. It includes a detailed view of the bar being inserted into a plastic housing. The assembly steps are numbered: **1** shows the bar being inserted into the housing, **2** shows a bolt being inserted into the housing, and **3** shows a cap being placed over the bolt. An inset diagram shows the bar being installed on a car roof, with arrows indicating the direction of installation. A small diagram at the bottom right shows the car roof with three mounting points labeled A, B, and C.

7



8



Kargo series



Acciaio / Steel

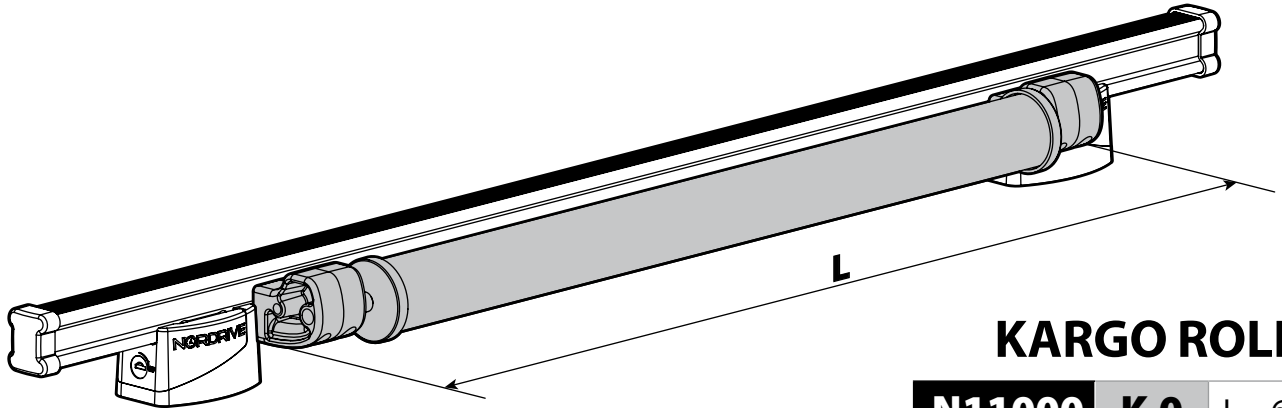

KARGO ROLLER

N11000	K-0	L = 64 cm
N11003	K-7	L = 96 cm

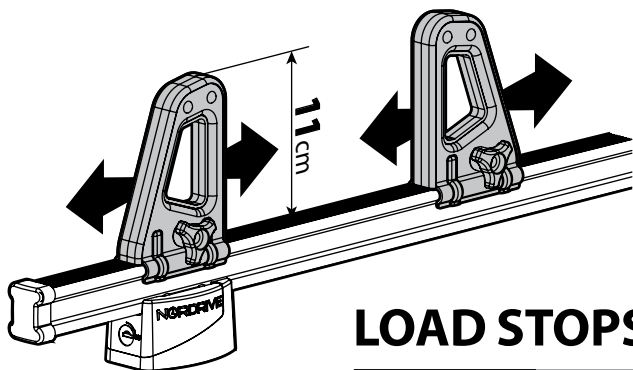

LOAD STOPS

N11001 K-1

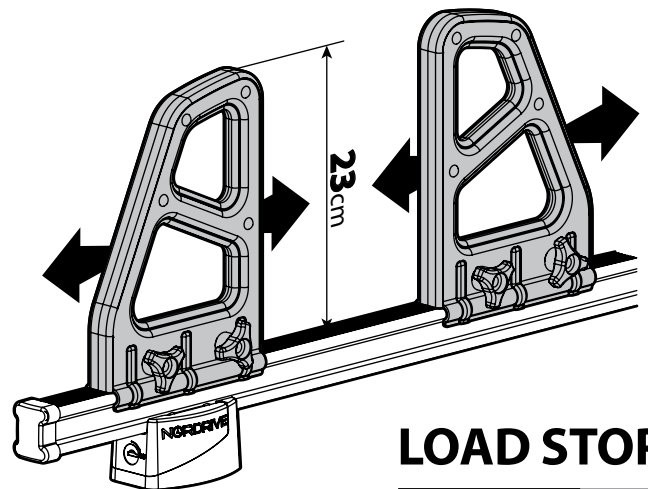

LOAD STOPS

N11002 K-2

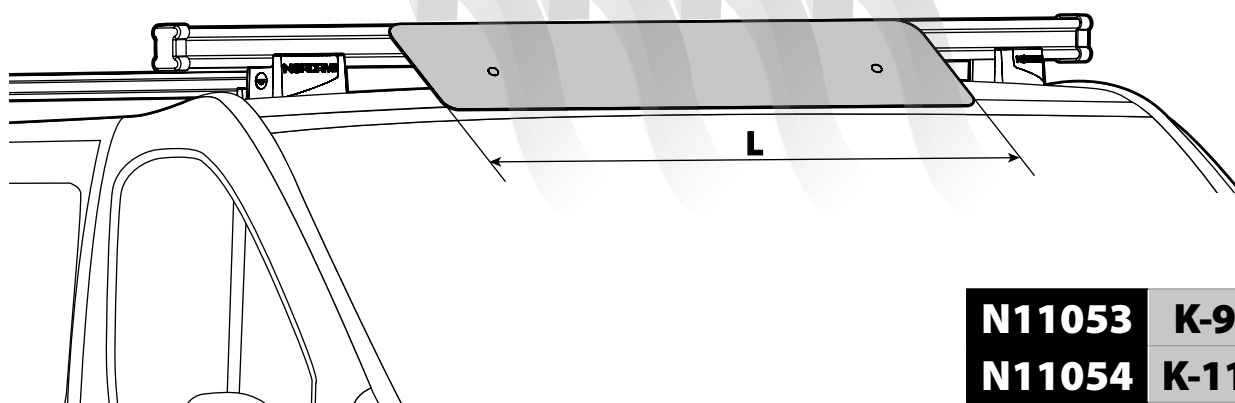

SPOILER

N11053	K-9	L = 95 cm
N11054	K-11	L = 110 cm

OPTIONALS PER / FOR / FÜR:

Kargo-Plus series

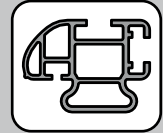

Alluminio / Aluminium

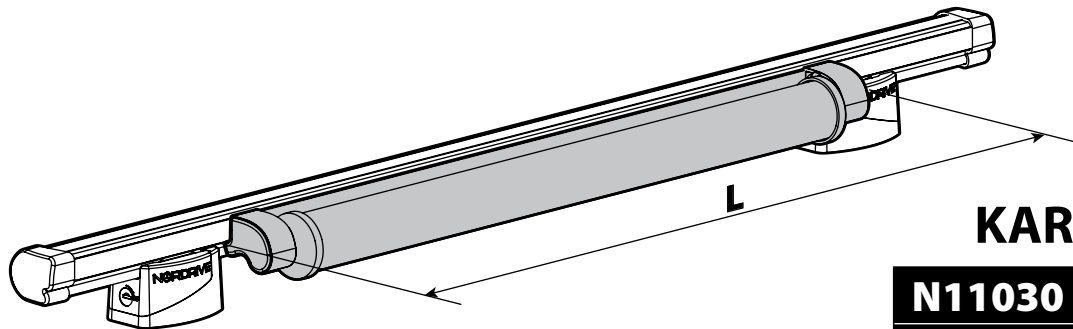

KARGO ROLLER

N11030	KP-0	L = 64 cm
N11034	KP-7	L = 96 cm

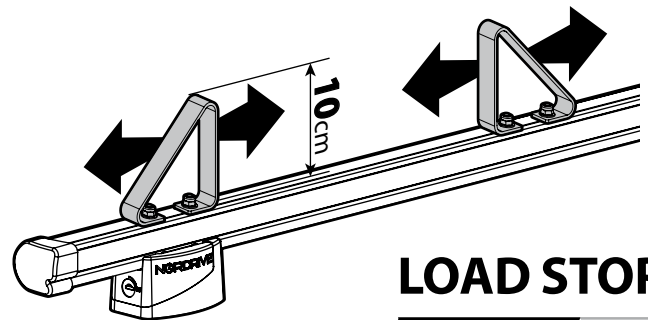
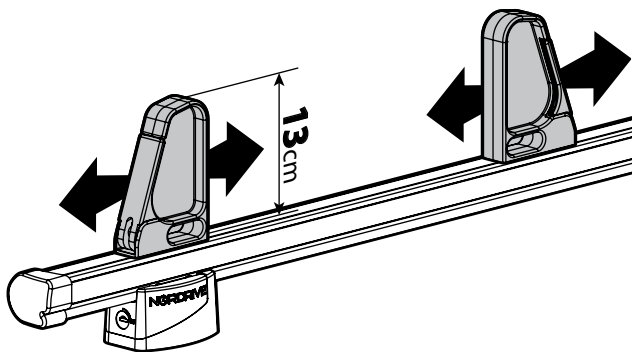

LOAD STOPS

N11031 KP-1

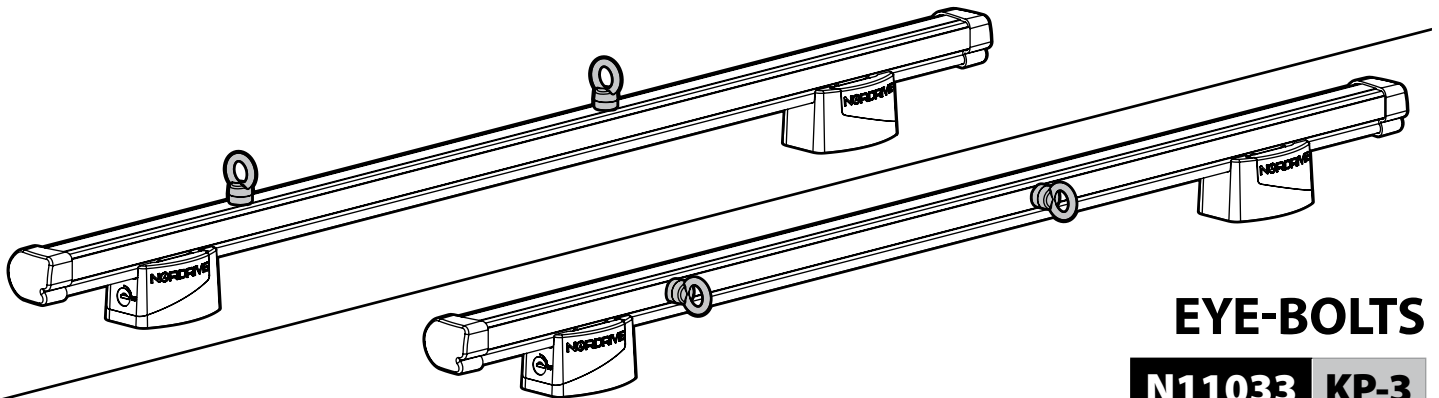

EYE-BOLTS

N11033 KP-3

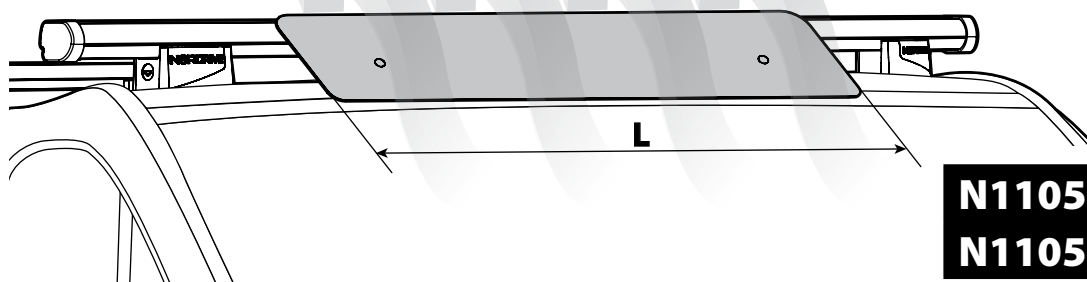

SPOILER

N11057	KP-9	L = 95 cm
N11058	KP-11	L = 110 cm

OPTIONALS PER / FOR / FÜR:

Kargo series



Acciaio / Steel

Kargo-Plus series

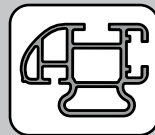

Alluminio / Aluminium

KARGO-TUBE

N11050	T200	L = 205 cm
N11051	T300	L = 305 cm
N11052	T400	L = 405 cm

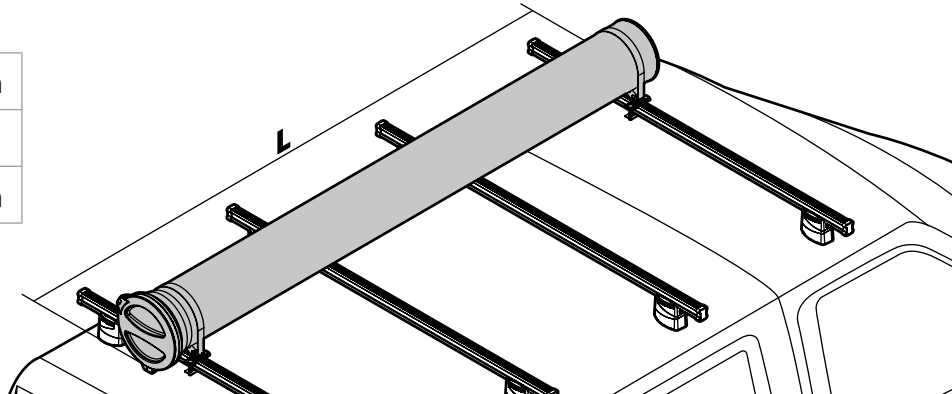

LADDER HOLDER STRAPS

N11065 U-5

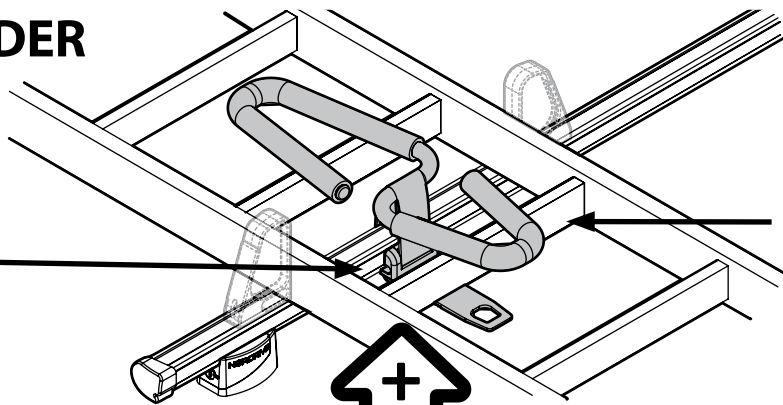
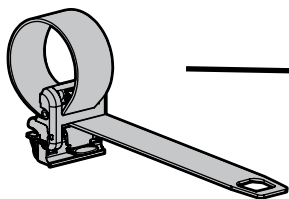

LADDER STEP ADAPTER

N11067 U-6

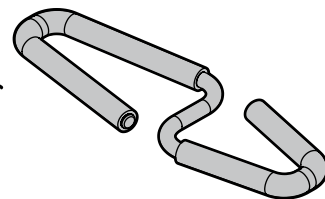

RICHIESTO
REQUIRED
REQUIS
ERFORDERLICH
NECESSARIO

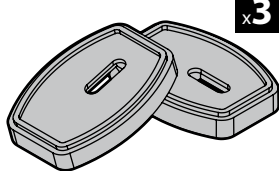

x3

Art. **N99985**

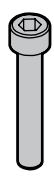

x4

M6x50
60CE6050

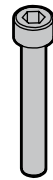

x2

M6x70
60CE6070

=

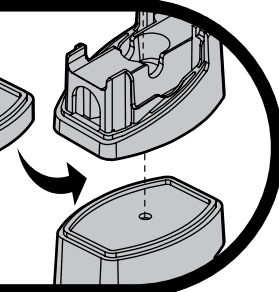
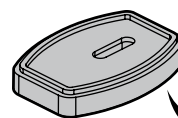

EXTENSION ROLLER

N11020	U-0	L = 64 cm
N11021	U-7	L = 96 cm

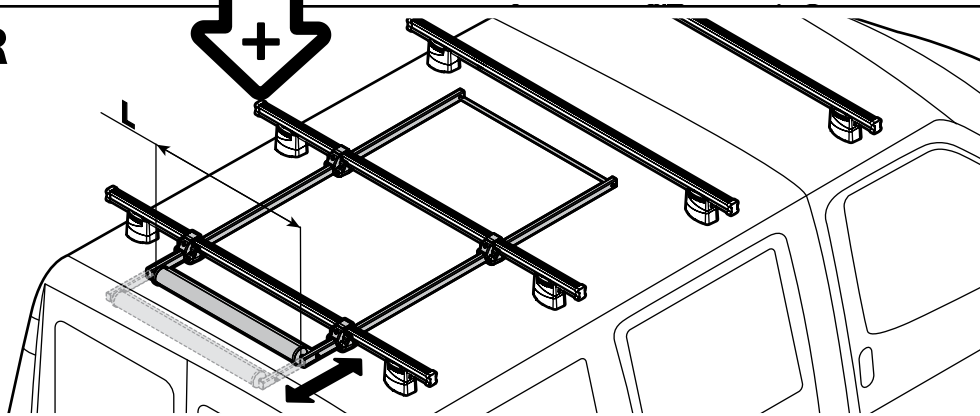

- (I) Lotto di produzione da comunicare per eventuali ricambi
- (GB) Production lot number to be communicated for any spare parts
- (F) Lot de production à communiquer pour toute pièce de rechange
- (D) Produktionscharge für eventuelle Ersatzteile
- (E) Lote de producción a comunicar por cualquier repuesto

Lot.

NORDRIVE®
TRANSPORT SOLUTIONS

NORDRIVE® is a registered trademark of
LAMPA S.p.A.
Via G. Rossa 53/55, 46019 Viadana (MN) ITALY
Tel. +39 0375 820700
UNI EN ISO 9001:2008 Certified Company
www.nordrive.it
www.lampa.it